

CHARLES MIX COUNTY, SOUTH DAKOTA.

Proceedings of the Board of County Commissioners

Wheeler South Dakota January 7th 1913

The Board of County Commissioners met in regular session with W^m F Brazzell Joseph Lindquist K.F. Wynia & H.G. Wilson County Auditor present

The minutes of the last meeting were read and approved.

The official bond of Ed Astin having been approved by the clerk of courts and Ed Astin having taken the oath of office as county commissioner of commissioner District No 3 took his seat on the Board of County Commissioners K.F. Wynia retiring.

It was moved and seconded that Joseph Lindquist act as chairman of the board for the year 1913. motion carried

On motion the following resolution was adopted.

Be it resolved that the following named banks of Charles Mix county be designated as depositories for county funds as provided by sections 349 to 351 inclusive of Political Code of S.D. and the maximum amount to be deposited in each of said depositories is hereby fixed at one half of the capital stock of each subject to the giving of proper bonds.

Name of Depository	Maximum amt of Deposit
Platte State Bank. Platte	\$ 12 500
Commercial State Bank Platte	12 500
Farmers State Bank Platte	10 000
Bank of Geddes. Geddes.	2 500
Charles Mix County Bank Geddes	12 500
Lakeside State Bank. Lake Andes	7 500
Valley State Bank Lake Andes.	6 250
Andes State Bank Ravinia	7 500
Ravinia State Bank Ravinia	5 000
Wagner State Bank Wagner	10 000
Commercial State Bank Wagner	5 000
First State Bank Wagner	10 000
Security State Bank Dante	5 000
County Seat State Bank Wheeler	2 500

Be it resolved, that no further depository bonds will be accepted which are signed by any officer stockholder or director of any bank seeking to be made a depository of county funds.

On motion the following bills were allowed.

K F Wynia Per diem committee work & mileage \$34 40

COMMISSIONER'S RECORD, "3,"

Perkins Bros. Co., Printers and Binders, Sioux City, Iowa.

L W Raffle Sheriff fees for Or ending Dec 31 1912 595⁶⁰
 L W Raffle Jailers fees for Or ending Dec 31 1912 191⁰⁰
 L W Raffle Office Expense " " " " 114⁶⁶
 F J Kaberna Court Certificate No 1408 55⁰⁰
 N. B Beck Office Expense State Atty or ending Dec 31 83³⁰

On motion the following official Bonds were approved.

Knut K Langland	County Treasurer	\$100 00 0.
F. J. Kaberna	County Auditor	2500.
T F Ward.	County Judge	2500.
L W Raffle	County Sheriff	8000.
J. E. Craig	Clerk of Courts	1500.
Bora E Stone	County Supt of Schools.	500.
N B Beck	States Attorney	1000.
E. L. Day	County Coroner	1500.
S. P. Jewett	Justice of the Peace	500.
E. R. Remington	Justice of the Peace	500.
J. F. Nichols	Justice of the Peace	500.
Frank Patton	Justice of the Peace	500.
L N Skillings	County Constable	500.
Wm Hunkley	County Constable.	500.

The official bond of C F Carroll Register of Deeds \$1500 was approved on condition that a new bond be furnished within 20 days. If new bond is not furnished within said time office to become vacant.

On motion the following bills were allowed.

E R Remington	Appraiser in Isaac Good horse slaughter case	5 ⁰⁰
John Bundy	" " " " " " " "	3 ⁰⁰
E P Davidson	" " " " " " " "	3 ⁰⁰
Wm J Wolf.	Justice fee " " " " " "	2 ⁸⁰
Guy Lyons.	Witness fee in case of State vs L Kitterman	1 ¹⁰
Art Davis	" " " " " " " "	1 ¹⁰
S. P. Jewett	Justice " " " " " " " "	7 ⁵⁰
L N Skillings	Constable " " " " " " " "	9 ³⁰
Jay Welch	Juror " " " " " " " "	2 ¹⁰
Bert Tucker	" " " " " " " "	2 ¹⁰
John Bell.	" " " " " " " "	2 ¹⁰
Charles Edberg	" " " " " " " "	2 ¹⁰
John Crowley	" " " " " " " "	2 ¹⁰
Jasper Newton	" " " " " " " "	2 ¹²
Frank Silire	Witness " " " " " " Bowman	3 ⁶⁰
L Gable.	" " " " " " " "	3 ⁶⁰
W W Evers	" " " " " " " "	3 ⁶⁰

CHARLES MIX COUNTY, SOUTH DAKOTA.

H K Gohme	witness fee in case of state vs Bowman	3 ⁶⁰
S P Jewett	Justice fee in " " " " " "	5 ³⁵
Anna Newman	Witness " " " " " " Ole Newman	1 ⁵⁰
Elizabeth Newman	" " " " " " " "	1 ⁵⁰
J E Tipton	" " " " " " " "	1 ⁵⁰
S P Jewett	" " " " " " " "	7 ³⁰
G M Shuck	constable " " " " " " " "	19 ³⁰
S P Jewett	Justice " " " " " " Ed Ferris	5 ³⁰
S P Jewett	" " " " " " " " Willie Ferris	2 ⁴⁵
F E McLaughlin	Witness " " " " " " Le Palmage	1 ¹⁰
Florence Nichols	" " " " " " " "	1 ¹⁰
Mrs A L Clements	" " " " " " " "	1 ¹⁰
Mr A L Clements	" " " " " " " "	1 ¹⁰
Nels Holmquist	" " " " " " " "	1 ¹⁰
Geo M Shuck	" " " " " " " "	1 ¹⁰
Joe Summers	" " " " " " " "	1 ¹⁰
A B Beck	" " " " " " " "	1 ¹⁰
S P Jewett	Justice " " " " " " " "	8 ⁶⁰
Geo M Shuck	constable " " " " " " " "	3 ⁴⁵
Vincent Kaberna	Justice fee " " " " " " W Montague	2 ⁵⁵
Ralph Parker	constable " " " " " " " "	9 ²⁵
Ralph Parker	constable " " " " " " " " Le Jones	15 ⁵⁰
Vincent Kaberna	Justice " " " " " " " "	2 ⁵⁵
Vincent Kaberna	" " " " " " " " Tammen	7 ⁰⁰
Wm Hinkley	constable fee " " " " " " " "	6 ²⁰
Harry Thompson	Summoning jury " " " " " " " "	3 ⁵⁰
W. C. Donahue	Juror fee in case of state vs " " " "	1 ¹⁰
F S Strobbelu	" " " " " " " " " "	1 ¹⁰
H C Schneider	" " " " " " " " " "	1 ¹⁰
M J Hefron	" " " " " " " " " "	1 ¹⁰
Jack London	" " " " " " " " " "	1 ¹⁰
J E Lushbaugh	" " " " " " " " " "	1 ¹⁰
Thas H Morrison	" " " " " " " " " " Weaver & Foster	1 ¹⁰
Wm Ford	" " " " " " " " " "	1 ¹⁰
Vincent Kaberna	Justice " " " " " " " "	6 ⁵⁵
Wm Hinkley	constable " " " " " " " "	12 ⁵⁰
Vincent Kaberna	Justice fee in case of state vs Kopke	7 ⁴⁰
Wm Hinkley	constable " " " " " " " "	12 ²⁰

On motion the Board adjourned to meet Jan 8 1913

COMMISSIONER'S RECORD, "3,"

Perkins Bros. Co., Printers and Binders, Sioux City, Iowa.

Jan 8 1913

The Board met pursuant to adjournment with all members present.

On motion the following transfer of county funds were made

From the Penalty & Interest fund to the Bridge fund	\$2,200 ⁰⁰
From the Insane fund to the Bridge fund	\$800 ⁰⁰
From the Special Salary fund to the Bridge fund	\$1,000 ⁰⁰

On motion it was agreed that all bills of members of Registration Boards for the 1912 election be paid from the County General fund at the rate of \$3.00 per day + and \$3⁰⁰ be paid to each City Auditor, and to each clerk of incorporated towns and to each clerk of civil townships, for preparing and pasting the registration lists.

On motion the following bills were allowed

J. N. Hosford. Attorney by order of Court Bowman and spotted eagle lenses. 50⁰⁰

Mitchel Publishing Co. County Supplies	39 ⁰⁰
Brown Saenger County Supplies.	276 ⁷⁰
Will A Beach Pt Co. County Supplies	300 ⁰⁰
A Amundson Provisions for Co. Poor Schuerdens.	95 ⁸⁶
A Amundson Provisions for Co. Poor Mrs Lushman	39 ⁰²
Robert Thompson Road work Wahehe Twp.	15 ⁰⁰
J. N. Oueal Co. Lake Andes coal for Co. Poor Branson	31 ⁸⁰
Western Engineering Co. Inspecting Co. Bridges & Mileage	56 ⁵⁰
Charles Marshall. Sheriffs assistance arrest of spotted eagle	5 ⁰⁰
O. N. Branson Hauling water for Co. Poor.	3 ²⁵
Geddes Record. County Printing	112 ⁷⁵
A. H. Kessicker Provisions for Co. Poor	10 ²⁰
Platte Tribune County Printing	112 ⁷⁵
S. B. Nyant. Repairs on Court House.	2 ⁵⁰
M. C. Nartzer Kerosine for Court House.	1 ⁸⁰
F. F. Ruble & Will Sanders. Digging Grave for Peter Frank Jensen	7 ²⁰
Fullerton Lumber Co. Platte coal for Sheriff.	27 ⁷⁵
Chas. Ree. Road work in Rouse Twp.	13 ⁰⁰
David Johndron. " " " "	18 ⁴⁰
Paul Johndron. " " " "	7 ²⁰
Felix Johndron. " " " "	9 ²⁰
Stephen. Johndron. " " " "	12 ⁴⁰
Asa Johndron. " " " "	9 ²⁰
Joseph Bates. " " " "	14 ⁰⁰
L. P. Rouse. " " " "	36 ⁰⁰
Ed Bradley. Grading up to Bridge in Rouse Twp	394 ¹⁵
F. J. Kaberna. Postage for Treasurers Office Dec 1912	9 ³⁰

CHARLES MIX COUNTY, SOUTH DAKOTA.

Laura Signall Taking and transcribing testimony in three state cases	35 ⁰⁰
Lake Andes Ware County Printing	46 ⁰⁰
Educator School Supply Co County Supplies	20 ¹⁷
J H Ouel Co Wagner one bridge plank.	1 ⁷⁰
Silas Feather Road work in Rouse Twp	7 ⁹⁵
M. Vawrinek Provisions for Co Poor Ida Lumerin	10 ⁰⁰
Guy Neal Hauling coal for County	39 ⁵⁴
D. C. Tel Co. Lake Andes County Tolls.	1 ⁷⁵
NE Nordaker Provisions for Co Poor. Bobeldyke ²⁷⁰⁰ .	20 ⁰⁰
J E Leraig Fees & Office expense clerk of courts	22 ²⁰
George Shearer Per diem & mileage Board of Education	11 ⁰⁰
J H Ouel & Co Wagner material for bridge	89 ¹⁵
E F Churchill Hauling coal for Court House	10 ¹⁸
R L Baker Taking testimony and transcribing same in case of state vs Kopke	31 ³⁰
L F Lutes Board for Co Prisoners	116 ⁵⁰
E L Cantwill Unpaid bal on the L H Yeager & Co Poor	13 ⁰⁰
L N Gross. Sheriff's assistance Norgaard case	12 ⁰⁰
Geo A Ogle County Assess	37 ⁵⁰
Krebs & Newton clothing for Neck Lonke	25 ⁰⁰ Claimed 18 ⁵⁰ Allowed.
J E C Wilson House rent for Poor (Baeths) 1 yr	60 ⁰⁰
T F Ward Office expense Co Judge for quarter ending Dec 31 1913	3 ⁶⁰
Dr F E Fyle. Examining Physician in the Kelly Insanity case	5 ⁰⁰
W F McCall. Attendance & mileage in the Kelly Insanity case	5 ²⁰
T F Ward Judges fees in the Kelly Insanity case.	4 ⁵⁰
Dr F E Fyle. Examining Physician in the Johann Meier Insanity case	5 ⁰⁰
W F McCall. Attendance and mileage in the Johann Meier Insanity case	5 ²⁰
T F Ward. Judges fees in the Johann Meier Insanity case	5 ⁷⁵
R B Millar constructing Booths for Ree Precinct	2 ⁰⁰
Dakota Central Telephone Co. Platte Tolls for County Sheriff L W Raffle	16 ⁰⁰
John Bell. Basket and burial of Fred Jensen's child	47 ⁰⁰ Claimed 35 ⁰⁰ Allowed.
R L Baker Stenographer, State Atty's assistance in County Seat contest.	14 ⁰⁰

COMMISSIONER'S RECORD, "3,"

John Bell Burial of Nick Louke 70²⁵ claimed 60²⁵ allowed
 F. C. Fox Board for Nick Louke 35⁰⁰
 E. J. Anderson Physician for Prisoner Spotted eagle 15⁰⁰
 O. D. Hodgson Digging grave for Nick Louke 5⁰⁰
 Missouri River Tel. Co. Platte Falls for Co. Officers. 18⁰⁵
 On motion the Board adjourned to meet Jan 9th 1913

Jan 9 1913

The Board met pursuant to adjournment with all members present.

On motion it was ordered that each commissioner designate one of the official newspapers for the year 1913 and in compliance with this order, Commissioner Astin selected and designated the Platte Tribune; Commissioner Lundquist selected and designated the Wheeler Courier and Commissioner Brazzill selected and designated the Wagner Post.

The County Board checked the County Treasurers Books and records from Jan 1 1913 to Jan 8 1913 inclusive and found the following named items due the county, which were turned over to the County of Charles Mix

Tax collected from Jan 1 to Jan 8 1913	746.41
Miscellaneous Receipts from Jan 1 to Jan 8 1913 as follows:	
County Gen	422.68
Special Salary.	246.45
School Land Lease.	188.00
Interest on Permanent School Funds	149.15
Interest on Deferred Payments	1400.61
Total	3153.00
Ledger Bal Dec 31 1912	43302.10
	46455.10
Deduct for Warrants Paid from Jan 1 to Jan 8	338.55
Jan 8 1913 Balance	46116.55

On motion the following bills were allowed.

F. J. Kaberna 9 days salary from Jan 1 to Jan 8	50 ⁰⁰
Farmers Hardware Co Voting Booths for Rhoda Twp	7 ⁵⁰
L. V. Naskell. Agt for New Era County Printing	51 ⁵⁵
L. V. Naskell " " " " " "	2 ²⁵
Carl Edberg Board for County Poor Petare Guardine	51 ⁰⁰
Missouri River Tel. Co. Wheeler Falls for Co. Officers	15 ⁰⁰
J. A. Seapy Physician for Poor. Lou Thompson ^{48⁰⁰} claimed.	40 ⁰⁰ allowed

CHARLES MIX COUNTY, SOUTH DAKOTA.

On motion the Board adjourned to meet Jan 10 1913

Jan 10 1913

The Board met pursuant to adjournment with all members present.

On motion the application of W & Price for additional depository for School Text Books at Wagner was rejected for the reason that one depository was deemed sufficient.

On motion the application of and petition of citizens of Dante for bounty aid for Mrs Wm Kade was considered and W & Brazzell appointed a committee to investigate and report at the next meeting.

The following county warrants having remained uncalled for and on file for more than six years the same were canceled and destroyed in the presence of the full board.

Quarterly Statement of Supt of Hospital for the Insane for Quarter ending Dec 31 1912

Name of Patient	Amount Paid	
Anton Kucera	48 00	
August Manske	48 00	
Andrew McKay	48 00	
Nettie McKay	48 00	
James McKinnon	48 00	
Siebrun Melum	48 00	
Peter Nyberg	48 00	
David Penrod	48 00	
Kate Pesicka	48 00	
Sam Severson	48 00	
Charles Stull	48 00	a
F W Tuckerman	48 00	
Julia Kelley	22 93	admitted Nov 18
John Meier	6 93	" " 23 died Dec 6 1912

COMMISSIONER'S RECORD, "3,"

Pepin Bros. Co., Printers and Binders, Sioux City, Iowa.

X On motion the following bills were allowed.

Walter H Frei	Pasting Registration Lists and acting on Board of Registration	\$6 ⁰⁰
L L Davis	Pasting Registration Lists and acting on Board of Registration	\$6 ⁰⁰
E O Lanam	Pasting Registration Lists and acting on Board of Registration	\$6 ⁰⁰
W F Vanderroot	Pasting Registration Lists and acting on Board of Registration	\$6 ⁰⁰
Leroy Beemer	Making & Pasting Registration Lists	3 ⁰⁰
John Stedronsky	1 day member of Board of Registration	3 ⁰⁰
S L Gable	1 Day service on " " "	3 ⁰⁰
J J Mohan	1 Day " " " "	3 ⁰⁰
L K S Marie	1 " " " "	3 ⁰⁰
E R Remington	1 " " " "	3 ⁰⁰
E G Walz	1 " " " "	3 ⁰⁰
C E Lien	1 " " " "	3 ⁰⁰
C P Davis	1 " " " "	3 ⁰⁰
J V Murphy	Office expense Co Supt Or ending '12/31	37 ⁵³
J V Murphy	Mileage to Mitchell Co Supt's meeting	12 ¹⁰

The County Board checked the books and records of The County Supt of Schools and found that all moneys, credits, accounts and property ^{had been} properly accounted for and on motion the report of J V Murphy _{County Supt of Schools was approved.}

On motion the Board adjourned to meet Jan 14 1913.

Jan 14 1913

The Board met pursuant to adjournment with all members present.

P A Hasford presented a claim of Henry Cool for \$35⁰⁰ for Hall rent in the Harben Disarmament base and same was rejected by the Board for the reason that the State should pay the claim.

The County Board adopted a complete set of Standard Specifications to be used in the construction of Steel Bridges & Cement Culverts for the year 1913 and placed the same on file and the County Auditor was instructed to advertise for bids and place the time of letting at one o'clock Feb 24th 1913.

CHARLES MIX COUNTY, SOUTH DAKOTA.

Notice to Contractors

Notice is hereby given that sealed bids will be received by the County Auditor of Charles Mix County at Wheeler South Dakota until 1 o'clock P.M. on the 24th day of February 1913 for the erection of all necessary steel and concrete bridges to be constructed upon the roads and highways within said county during the year 1913. in accordance with the conditions herein after contained and in accordance with plans and specifications on file in the office of the County Auditor of said county. All bids to be based upon said specifications and said plans. Said bids to be per lineal foot for the building of all of said bridges that may be required within said county for the year 1913. A certified check on some bank in South Dakota for \$500⁰⁰ must accompany each bid as a guarantee that the bidder, if awarded the contract for the bridges will within ten days execute and file with the County Auditor a surety bond to be approved by the County Commissioners in the amount of 5000⁰⁰ otherwise his check will be forfeited to the county as liquidated damages. All other checks will be returned to the bidder on the day the contract is awarded. The successful bidder or bidders for the construction of said bridges shall commence active work on the same ~~and~~ within sixty days after the date of contract and shall complete all work contracted for. on or before the 15th day of October 1913

The County Commissioners reserve the right to reject any and all bids or to accept any bid which may in their judgment be for the best interests of the County

Each bidder will be required to include in his bid the price for which he will construct necessary cement work for abutments and wing walls. Said price to be designated as per cubic yard. for necessary cement work to be constructed in the erection of abutments and wingwalls for said bridges

By order of the Board of County Commissioners

H. G. Wilson

County Auditor

The Board spent the balance of the day and adjourned to meet Jan 15th 1913

COMMISSIONER'S RECORD, "3,"

Jan 15th 1913

The Board met pursuant to adjournment with all members present.

The Board checked the books and records of the Registered of Deeds on fees collected and found that all money credits and accounts had been properly accounted for and on motion the report of G. H. Patrick Register of Deeds was approved.

On motion the following bills were approved.

Miss J Lemhan	Professional nurse for Jensen family	113 ²⁸ claimed 83 ²⁸ allowed	
Hanna Kearton	Professional nurse for Jensen family	74 ²⁸ claimed 54 ²⁸ Allowed	
James Hassenzer	making and pasting registry lists		3 ⁰⁰
L P Kundson	"		3 ⁰⁰
R F Powers	"		3 ⁰⁰
T J Bultsma	"		3 ⁰⁰
Ralph Albright	"		3 ⁰⁰
G W Gmtes	"		3 ⁰⁰
Philip Dermody	"		3 ⁰⁰
John Kubal	"		3 ⁰⁰
Charles Hrdlicka	"		3 ⁰⁰
H E Dimmick	"		3 ⁰⁰
Frank Denoma	"		3 ⁰⁰
L N Schichtl	"		3 ⁰⁰
R B Mellar	"		3 ⁰⁰
W N Frather	"		3 ⁰⁰
John T Morgan	"		3 ⁰⁰
E F Blair	"		3 ⁰⁰
L K Langland	"		3 ⁰⁰
G M Newman	"		3 ⁰⁰
Gilbert St Pierre	"		3 ⁰⁰
Frank Denoma	"	Primary Ed Notices	2 ⁰⁰

The Board spent the balance of the day checking the Auditors and Treasurers Books and records and on motion adjourned to meet Jan 16th 1913.

CHARLES MIX COUNTY, SOUTH DAKOTA.

Jan 16 1913

The Board met pursuant to adjournment with all members present.

The Depository bonds of The First State Bank of Wagner and Commercial State Bank of Platte covering application for county funds were approved by the Board of county commissioners.

The Annual report of States Attorney was examined and on motion same was approved.

The Board checked the books and records of the clerk of courts on fees and fines collected and found that all moneys credits and accounts belonging to the county had been properly accounted for and on motion the Report of J E Craig clerk of courts was approved.

On motion the following bills were allowed.

Sprague & Sons. Hauling coal for Bill Baker & F Williams	4 ⁵⁰
Will A Beach county supplies	300 ⁰⁰
R S Parker Mileage and expense Freeman & Martinic case	12 ⁰⁰
Jacob Schmidt Road to road on Douglas Co Line	53 ⁰⁰
G F Bucher Duplicate of No 9978 Bond on file	4 ⁵⁰
Dakota Central Tolls for Co Supt - Or Ending Dec 31	22 ⁵⁰
H G Wilson Office expense and Express & Freight paid	19 ⁵³
J E Craig ^{clerk} Reporting Births & Deaths. Vital Statistics	46 ²⁵
Farmers Co Op Co. Platte coal for Co Poor F Williams	4 ⁰⁰
Farmers Co Op Co. Platte. " " " " Bill Baker.	17 ⁵⁰
Farmers Co Op Co. Platte " " " " Mrs Patter	14 ⁰⁵
Williamson Bros. Provisions for Co Poor Wm Dodd.	10 ⁰⁰
John E Bell. Bedding for Co Poor. Jensen Family	8 ⁰⁰
Farmers Co Op Co. Wagner. coal for Co Poor Ida Limeron	9 ⁰⁰
Frank Schroeder Milk for Mrs Snyder. Co Poor.	6 ⁰⁰
A E Bassingham Co Supplies.	33 ⁵⁰
A E Bassingham Medicine for Co Poor Nick Lunke	21 ²⁵
A E Bassingham " " Prisoner Daily	3 ³⁵
A E Bassingham " " Co Poor M Jansen	1 ⁰⁰
A E Bassingham " " " (Frenchy)	4 ⁵⁰
A E Bassingham " " " Mrs Wood	4 ⁰⁰
G H Patrick D. Co. Tolls for Co Officers	11 ⁵⁴
G H Patrick clerk fire for Dec 7 days in Jan	50 ⁵⁰
Lewis Miller Hauling 1 Bbl Water.	50 cents

The Board spent the balance of the day checking the Auditors & Treasurers books & on motion adjourned to meet Jan 17 1913

COMMISSIONER'S RECORD, "3,"

Jan 17 1913

The Board met pursuant to adjournment with all members present.

On motion the application of Mame Emmons for an abatement of 1912 personal tax in Wabehe Twp was allowed for the reason of erroneous assessment.

On motion the 1912 tax sale list No 45 was ordered called in and redeemed by the County for the reason ~~tho~~ of erroneous assessment.

On motion the tax claim of Byron Nelson for refund of 1910 & 1911 road tax was rejected for the reason that the claim should be presented to the Town Board of Lone Tree Twp.

On motion the application of Christ Raabe for a partial reduction of valuation on S1/4 of SW1/4 Sec 21 Twp 96. Rge 66 for the year 1911 was rejected for the reason that the matter should have been presented to the Town Board of Equalization.

On motion the County Supt of Schools was allowed 600⁰⁰ for clerk or Deputy hire for the year 1913 to be paid monthly from the special salary fund.

On motion the County Auditor was allowed 600⁰⁰ for clerk or Deputy hire for the year 1913 to be paid monthly from the special salary fund.

On motion the County Treasurer was allowed 600⁰⁰ for clerk or Deputy hire for the year 1913 to be paid monthly from the special salary fund.

On motion it was agreed that the Register of Deeds be allowed 40 per cent of all fees collected in his office in excess of his salary for clerk or Deputy hire.

All applications and petitions pertaining to appropriations for road improvement and for the construction of Bridges were filed in the Auditor's office were laid on the table and action deferred until the next meeting of the County Board.

On motion the application of J E Andrews for a reduction of 1910 personal tax in Lake Aude was rejected.

On motion the Co Treas. was authorized to transfer the unexpended balances of the Del. Road fund of all Twp's to the civil funds of same Twp's and the balance of The Del Road fund of Wabehe & Rouse to Road fund of Wabehe and Rouse. There being no further need of Del. Road funds

CHARLES MIX COUNTY, SOUTH DAKOTA.

State of South Dakota }
 County of Charles Mix } ss.

In the matter of the petition for a change
 of boundary lines in White Swan School District
 No's 5th & 8

The petition of J F Maran and others filed July 20, 1912
 for a change of boundary lines of White Swan School Districts
 Nos 5th & 8 was called up for reconsideration as follows.

To annex the east half of section 1 Twp 95 Rge 66
 now within White Swan School District No 5 to White Swan
 School District No 8.

No protest having been entered against said change
 of boundary lines, and J F Maran having filed in the office
 of the county Auditor an agreement with the School Board of
 White Swan School District No 8 to waive demand on said
 school District No 8 for a second school house in said
 White Swan School District No 8 the Board of County Commrs.
 and the county Supt Lerby declare said petition granted.

Dated Jan 16 1913
 attest S S Wilson
 Co Auditor.

Joseph Ludwig
 Chairman of Board of Co Commrs
 Cora E Stone
 County Supt of Schools.

On motion the following bills were allowed.

F. E. Fyle. Physician for Co Poor Nick Lunke.	280 ³⁸ claimed 80 ³⁸ allowed
F E Fyle. Physician for Co Poor Jensen Family	434 ⁶⁰ claimed 274 ⁶⁰ allowed.
F E Fyle. Physician for Co poor Octave Girardine	73 ⁵⁰ claimed 60 ⁰⁰ allowed.
J E Craig clerks fees on transcripts	17 ⁰⁰
Wheeler Courier County Printing	274 ¹⁵
Charles Mix Co. News "	29 ³⁰
Geddes Building Co making & delivering Baths Lone Lake	26 ⁰⁰
O Co Mcalls. Medicine for Co Poor Mrs John Snyder	14 ⁰⁰
L D Gramblit Physician for Co Poor. " " "	25 ⁰⁰
Secretary of State. South Dakota Publicity Pamphlets	322 ⁰⁰
American Book Co. Chgo. School Text Books	3329 ⁰⁷
Gunn Co. Chgo. School Text Books	1266 ⁸⁷
Rand McTally Co Chgo. " " "	231 ³¹
Benz H Sauborn Dec. " " "	61 ⁰⁷
Silver Birdette Co. " " "	164 ⁷²
Educational Pub Co. " " "	433 ⁴⁸
B F Reynolds Co Supplies	17 ⁶⁵
J L Welch " "	4 ⁸⁰

COMMISSIONER'S RECORD, "3,"

Perkins Bros. Co., Printers and Binders, Sioux City, Iowa

The Board having completed the checking of the Auditors and treasurers records and Books found the same to be correct and on motion same was approved

On motion the following bills were allowed,

Mr F Brazzill Per diem Com Work & mileage 53⁵⁰

Ed Astin Per diem 2nd mileage 52²⁰

Mr F Brazzill Per diem Com Work & mileage 86⁰⁰

Joseph Lundquist Per diem Com Work & Mileage 78⁰⁰

On motion the Board adjourned to meet Feb 24 1913.

Attest H G Wilson

County Auditor.

Joseph Lundquist
Chairman

CHARLES MIX COUNTY, SOUTH DAKOTA.

Proceedings of The Board of County Commissioners

Special Meeting

Wheeler So Dak. Jan 29 1913

The Board of County Commissioners met in special session pursuant to call by the County Auditor for the purpose of considering the contests of the 1912 election pertaining to removal of the County Seat of said County and to transact any other business that might come before the Board at that time. All members of the County Board were present.

It was moved and seconded that the following resolution be passed.

Resolved, that the action of this Board wherein the States Attorney in and for Charles Mix County was directed and authorized to defend the action of A. H. Boynton vs County Commissioners contesting the County seat election between the towns of Wagner and Wheeler be and the same is hereby rescinded and,

Be it further resolved that the States Attorney or any one in his behalf take no further steps or incur further expense in relation to the procedure of said election and the said States Attorney is hereby directed and authorized to withdraw all appearance in said action in behalf of said Board of County Commissioners.

On the above motion Commissioner Brazzill voted yes and Commissioners Lindquist and Astin voted no and the motion was declared lost.

On motion the following bills were allowed.

Mark Campbell. work for Jensen Family #144 claimed 50 ⁰⁰	Allowed
Mrs L. A. Roraart Nurse for Typhoid Patients Jensen Family	75 ⁰⁰
Mrs C. Dauley Nurse for Typhoid Patients Jensen Family	75 ⁰⁰
Wm F Brazzill Per diem Com Work ^{ed} Mileage	16 ⁵⁰
Ed Astin Per diem Com Work ^{ed} Mileage	25 ⁷⁰
Joseph Lindquist " " " " "	6 ⁰⁰

The County Auditor was directed to prepare a statement showing the number and cost of all Bridges in the County showing the location and cost of each

On motion the Board adjourned to meet Feb 24 1913

Attest A. G. Nelson County Auditor Joseph Lindquist
Chairman

COMMISSIONER'S RECORD, "3,"

Perkins Bros. Co., Printers and Binders, Sioux City, Iowa

Proceedings of The Board of County Commissioners
Wheeler South Dakota Feb 24 1913

The Board of County Commissioners met in
adjourned session pursuant to adjournment taken June 24

All members were present

The Board having under consideration the proposals
submitted for the erection of all necessary steel and
concrete bridges to be constructed upon the roads and
highways within Charles Mix County South Dakota for the
year 1913 found the following prices submitted by the
following competing bridge companies in accordance with plans and
specifications on file with the county auditor

	Minnesota Bridge Co.	Turner Bridge Co.	Medland Bridge Co.	H. E. Shorthell Co.	Marshall Engineering Co.	Standard Bridge Co.
For Pin connected Bridges with 1600 lb capacity with two lines of angle railing designed to carry a wood floor steel joists and floor included						
Per Lineal Foot Spans 36 to 44 ft	15 ²⁵	15 ⁹⁵	15 ⁹⁵	15 ⁸⁰	15 ⁵⁰	14 ²⁵
" " " 45 to 49 "	17 ¹⁰	17 ⁰⁰	16 ⁷⁰	16 ⁶⁰	16 ⁴⁰	14 ⁸⁵
" " " 50 to 54 "	17 ⁴⁵	17 ⁵⁰	17 ¹⁵	17 ²⁵	16 ⁹⁰	15 ³⁵
" " " 55 to 59 "	18 ²⁰	18 ⁰⁰	17 ⁶⁵	17 ⁷⁰	17 ⁴⁰	15 ⁶⁰
" " " 60 to 64 "	18 ²⁵	18 ¹⁰	17 ⁸⁹	17 ⁸⁵	17 ⁶⁵	16 ⁰⁵
" " " 65 to 69 "	18 ⁶⁰	18 ⁵⁰	18 ⁴³	18 ⁵⁰	18 ³⁵	16 ⁸⁵
" " " 70 to 74 "	19 ¹⁰	19 ⁰⁰	18 ⁴⁶	18 ⁶⁰	18 ⁴⁰	17 ⁰⁵
" " " 75 to 80 "	19 ⁴⁵	19 ⁵⁰	18 ⁹⁴	19 ⁰⁰	19 ⁰⁰	17 ⁶⁰
For Pin connected bridges 1600 lb capacity with angle railing designed to carry concrete floor and including steel joists and wood floor						
Per Lineal Foot Spans 36 to 44 ft	18 ⁷⁵	18 ⁷⁵	18 ⁹⁷	18 ⁹⁰	18 ⁹⁰	17 ⁶⁰
" " " 45 to 49 "	20 ⁴⁰	20 ⁴⁵	22 ¹⁵	20 ²⁵	19 ⁸⁵	19 ¹⁰
" " " 50 to 54 "	21 ¹⁰	21 ⁰⁰	20 ⁸⁰	20 ⁹⁵	20 ⁸⁵	20 ²⁵
" " " 55 to 59 "	21 ⁹⁰	22 ⁰⁰	21 ⁶⁰	21 ⁷⁵	21 ⁶⁵	21 ¹⁰
" " " 60 to 64 "	23 ⁴⁰	22 ⁹⁵	22 ²⁵	22 ⁹⁰	22 ⁹⁰	22 ⁶⁵
" " " 65 to 69 "	24 ²⁰	24 ⁰⁰	24 ⁰¹	23 ⁸⁵	23 ⁹⁰	23 ¹⁰
" " " 70 to 74 "	25 ¹⁰	25 ⁰⁰	24 ⁶²	24 ⁶⁵	24 ⁶⁵	24 ¹⁰
" " " 75 to 80 "	26 ³⁰	26 ⁰⁰	27 ⁹⁰	25 ⁷⁵	25 ⁰⁰	24 ⁹⁰

CHARLES MIX COUNTY, SOUTH DAKOTA.

For riveted Bridges with angle railing
1600th capacity designed to carry concrete
floor and including steel joists and
wood floor.

	Massachusetts Bridge Co.	Twin City Bridge Co.	Midland Bridge Co.	A E Sharthill Bridge Co.	Monar et Engineering Co.	Standard Bridge Co.
Per lineal foot Spans 36 to 44 ft	19 ⁴⁰	19 ⁴⁵	18 ⁷²	19 ⁰⁰	18 ⁸⁵	17 ⁸⁵
" " " " 45 to 49 "	22 ³⁵	22 ⁴⁵	21 ⁹⁰	22 ⁰⁰	21 ⁸⁰	20 ⁴⁰
" " " " 50 to 54 "	23 ¹⁰	23 ⁰⁰	22 ⁰⁰	22 ⁵⁰	21 ²⁵	21 ²⁵
" " " " 55 to 59 "	24 ⁶⁰	24 ⁴⁵	24 ⁰⁵	24 ²⁵	23 ⁴⁰	23 ⁰⁵
" " " " 60 to 64 "	24 ⁸⁵	25 ⁰⁰	24 ⁵⁰	24 ⁷⁵	23 ⁷⁰	23 ²⁵
" " " " 65 to 69 "	25 ⁸⁵	26 ⁰⁰	24 ⁹⁰	25 ⁰⁰	24 ⁰⁰	23 ⁴⁵
" " " " 70 to 74 "	26 ⁸⁰	26 ⁷⁰	25 ⁵²	26 ⁰⁰	24 ⁹⁰	24 ⁰⁵
" " " " 75 to 80 "	28 ⁰⁰	27 ⁴⁵	26 ⁴⁴	26 ⁷⁵	26 ⁴⁵	26 ¹⁰

For 1600th I Beam super structure with
railing designed to carry concrete floor
and wood floor included in prices.

Spans per lineal foot up to 14 feet	9 ¹⁰	8 ⁷⁵	8 ⁵²	8 ⁷⁵	8 ⁴⁵	8 ⁰⁰
" " " " 15 to 18 "	9 ⁴⁰	9 ⁴⁵	8 ⁹⁶	9 ⁰⁰	8 ⁷⁵	8 ⁶⁰
" " " " 19 to 20 "	10 ⁷⁰	11 ⁰⁰	10 ⁶³	10 ⁷⁵	10 ⁴⁰	10 ¹⁰
" " " " 21 to 28 "	12 ⁶⁵	12 ²⁵	12 ¹⁴	12 ⁵⁰	12 ⁰⁰	11 ⁸⁵
" " " " 29 to 34 "	15 ⁴⁰	15 ⁴⁵	14 ⁹⁵	15 ⁵⁰	14 ⁹⁰	14 ⁷⁰

For prices on 8 lines of steel joists
consisting of two channels and 6 I Beams
of the sizes given below the price
per lineal foot of Bridge

8 Lines of 6 in Joists per lineal foot	4 ³⁰	4 ³³	4 ⁰⁰	4 ²⁵	3 ⁹⁰	3 ⁵⁵
" " " 7	4 ⁶⁵	4 ⁴⁸	4 ¹⁰	4 ³⁵	4 ¹⁰	3 ⁷⁰
" " " 8	5 ⁶⁵	5 ⁴⁸	5 ²⁵	5 ⁵⁰	5 ⁵⁰	4 ⁷⁵
" " " 9	5 ⁹⁵	5 ⁷⁸	5 ⁵⁰	5 ⁷⁵	6 ⁰⁰	5 ⁰⁰
" " " 10	7 ⁴⁵	7 ⁴⁸	7 ¹⁰	7 ³⁵	7 ⁴⁰	6 ²⁰
" " " 12	10 ⁸⁵	11 ⁰⁰	10 ⁶⁵	10 ⁷⁵	10 ⁸⁰	9 ⁹⁰
" " " 15	13 ⁴⁵	13 ⁵⁰	12 ⁹³	13 ⁰⁰	12 ⁹⁰	12 ¹⁵
" " " 18	16 ³⁵	16 ⁴⁸	16 ⁹⁴	16 ⁷⁵	16 ⁴⁵	16 ⁰⁰

Steel tubes per foot of each tube including
concrete, Pier Beams, Struts and sways.

Tubes 30 inch in dia 1/4 metal	7 ⁶⁰	7 ³⁸	7 ⁵⁰	7 ⁵⁰	7 ²⁵	6 ²⁵
" 36 " " " "	8 ⁴⁰	8 ⁰⁸	7 ⁹⁰	8 ⁰⁰	7 ⁸⁵	6 ⁷⁵
" 42 " " " "	9 ⁶⁰	8 ⁴⁰	8 ³⁵	8 ⁵⁰	8 ⁴⁰	7 ³⁵

COMMISSIONER'S RECORD, "3,"

Perkins Bros. Co., Printers and Binders, Sioux City, Iowa

	Monarch Bridge Co.	A. G. Shorthill Co.	Midland Bridge Co.	T. J. Leach Bridge Co.	Standard Bridge Co.	
Channel caps for steel or wooden Bridges						
Six inch channel caps (2 channels)	.90	98¢	1.00	1.00	95¢	90¢
Seven " " " " "	1.30	1.14	1.25	1.25	1.15	1.10
Eight " " " " "	1.65	1.72	1.75	1.65	1.65	1.25
Steel Piles driven in place per lineal foot of pile of the following sizes						
Six inch I Beam Piles	1.30	1.24	90¢	1.00	95¢	90¢
Seven " " " " "	1.45	1.49	1.25	1.35	1.25	1.00
Eight " " " " "	1.60	1.64	1.57	1.55	1.45	1.25
Nine " " " " "	1.90	1.99	1.84	1.90	1.65	1.45
Ten " " " " "	2.00	2.24	1.95	2.00	1.95	1.85
Eight foot special			3.50	3.00		2.25
For any concrete abutments built per cubic yard.						
Above water line	14.00	13.35	12.65	12.35	15.00	9.00
Below " " " " "	18.00	16.00	16.60	16.85	18.00	12.00
Concrete Backing	14.00	13.38	12.67	12.85	15.00	9.00
Concrete floors per lineal foot of Bridge as per plan and	6.20	6.58	6.39	7.00	6.50	5.25
Reinforcing rods used in Concrete Backing prices per 100 th in place	4.00	4.00	4.00	3.87	4.50	3.00
Washington fir lumber in place per thousand feet	40.00	43.00	41.50	42.50	42.00	34.50
Washington fir wood piles per foot	41¢	44¢	41¢	43¢	52¢	38¢
Red cedar Piling per foot	40¢	40¢	39¢	40¢	52¢	37¢
Standard Wood Bridges 16 ft Roadway per lineal foot of superstructure	4.85	4.84	4.65	4.70	4.40	3.90

After fully examining the proposals of the competing bridge companies ^{On motion} the contract for the construction of bridges in and for Charles Mix County South Dakota for the year 1913 was awarded to the Standard Bridge Company Omaha Neb.

CHARLES MIX COUNTY, SOUTH DAKOTA.

The Board having under consideration the adoption of specifications to be used in the annual letting of metal culvert contract adopted and filed specification marked "A" and County Auditor was instructed to advertise for sealed bids and set the time and place for receiving such at Wheeler on April 3 1913

On motion the following bills were allowed.

Charles Mix Co Bank. Court certificates	157 ⁰⁰
A B Beck Expenses State attorneys office	62 ⁵⁰
W ^m Miller Hauling water for court house	6 ⁰⁰
Platte State Bank. Court certificates	207 ⁶⁰
Valley State Bank. Court certificates	13 ⁴⁰
Platte State Bank. Court certificates	111 ⁸⁰
Bank of Geddes. Court certificates	91 ⁶⁰
Mrs Harry Hodges. Nursing & other work in Jensen home	70 ⁰⁰
K K Lundlund. Postage Treas Office	32 ⁰⁰
Lakeside State Bank.	37 ²⁰
H D James Court certificate	2 ⁰⁰
Bank of Geddes. Court certificates	57 ⁴⁰
Security State Bank. Court certificates	41 ⁰⁰
First State Bank. " "	51 ⁷⁰
W ^m F Brazzell Per diem Com Work & mileage	26 ⁵⁰
Ed Austin Per diem Com Work mileage	10 ⁷⁰
Joseph Lindquist " "	10 ⁰⁰

The application of Johnson Bros. Land Co. for a refund of 1912 Tax erroneously paid on Lot 7, Block 51, City of Geddes, was allowed and said tax ordered returned on the Tax List.

On motion the Board adjourned to meet March 1, 1913.

Attest H S Nelson
County Auditor

Joseph Lindquist
Chairman

COMMISSIONER'S RECORD, "3,"

Proceedings of the Board of County Commissioners.

Recorder. S. Dak. Mar 1st 1913.

Board of County Commissioners met pursuant to adjournment taken Feb 24th 1913. Present Joseph Lindquist Chairman; H. B. Brazzell, Ed. Austin. H. J. Kobernas County Auditor.

The Clerk of Courts filed the following request to the Honorable Board of County Commissioners of Charles Mix County, S. Dak.

You are hereby requested to extend the jury list, according to law, by adding 44 names, thereby making a total jury list of (200) two hundred names.

Feb 28th 1913.

J. E. Craig, Clerk of Courts.

The Board proceeded to comply with the above request and the following names were chosen to keep the (200) two hundred names of the jury list intact.

Anton, Hononield,	Bryan, Huff	Putnam, S. Effertys	Moore, S. up
H. S. Sley,	Carroll	Waters & Lynch	" "
J. W. Harris,	Thateau Creek	Joseph. Beyer	Plain Center
John. Delina	Goose Lake	John. L. Johnson.	Platte
Joseph Hupka	" "	C. N. Schichtl	" "
L. Van. Dam,	Hamilton	W. G. Blair	Rhoda
Henry. Carver,	Highland	Venzel. Jirisek.	Rice
H. J. Kipp.	Jackson	F. Bucholz	" "
John. Burns	" "	John. Hedved	" "
H. A. Ly rose.	" "	Louis. Cote	Rouse
H. Frank. Lipsdskog.	" "	W. H. Lyman.	Signal
J. J. Thompson.	" "	Herman. Habel.	White Swan
W. A. Dimick.	Lake George.	Anton Hupka	" "
Chas. Heaton.	La Roche.	B. H. Freeman	" "
J. A. Newman.	Laurence.	W. J. Cooper	Jeddes City
H. S. Dunmore.	" "	E. E. Wilson.	Platte
Joseph. Wolzbauer.	Lone Tree	George. Gregory.	" "
Anton. Hillous	" "	Alfon. Amundson	Wagner
H. J. Lyson	Moore.	C. V. Campbell	" "

CHARLES MIX COUNTY, SOUTH DAKOTA.

W. H. Loughlin, Wagoner City. Chas. Steedronsky, Lake Andes City
 A. A. Boynton " " E. R. Remington " "
 J. Morgan Lake Andes " L. C. Pier. Ravinia Town.

On motion the Depository Bonds, of the several Banks for County funds, were approved as follows:

- ✓ Platte State Bank.
- ✓ Farmers State Bank.
- ✓ Charles Mix County Bank.
- ✓ Bank of Yeddes.
- ✓ Lakeside State Bank.
- ✓ Wagoner State Bank.
- ✓ Security State Bank.
- ✓ County Seat State Bank.

Refund order # 512

On motion the County Auditor, was instructed to issue refunding order to W. H. Wilson, for 1912 taxes on the West half lots 13-14-15 - Blk 16 Platte City, which tax had been erroneously paid, said tax was ordered to be re-extended on 1912 tax list.

On motion the Abstractor's Bond of Albert Boynton of \$10,000.00 was approved.

Refund order # 513

On motion the County Auditor was instructed to issue refunding order to Gus. Meidemeier, for 1912 taxes on lots 14-15 Blk 9, City of Wagoner, which tax had been erroneously paid, said tax was ordered to be re-extended on 1912 tax lists.

On motion the following bills were read and allowed.

J. H. Smeal & Co., Wagoner, S. Dak., for metal culverts for Route 1 Township. Claimed \$223.84	Allowed \$213.84
J. H. Smeal & Co., Wagoner, S. Dak., for metal culverts for Choteau Creek Township. # 46.80	# 46.80
Chas. H. Carroll. Postage & Office expenses	17.02
Dakota Central Tel. Co. Calls for County Officers	9.90
Chas. H. Carroll. Clerk's fee. Jan & Feb.	102.80
Bank of Yeddes. Court Certificates.	31.80
Wagoner State Bank. " "	15.90
Chas. Mix Co Bank. " "	23.10
W. J. Overkamp. " "	12.30
L. B. French. " "	2.10
Lewis Jan. " "	37.20

COMMISSIONER'S RECORD, "3,"

Perkins Bros. Co., Printers and Binders, Sioux City, Iowa.

Bank of Judds	Cont. Certificates	\$ 1120
Warren, Berada	" "	40.90
Carl Denker	" "	34.00
Kennet Shaw	" "	30.30
First State Bank, Platte	" "	510.80
H. J. Mauchinney	Sheriff at February term of Court	40.00
H. J. Wilson	Office expense	35.40
H. J. Wilson	Paid for County Supplies	11.50
Mr. F. Braggell	Per diem, com, work and mileage	23.00
E. d. Astin	" " " " " "	23.00
Joseph Lindquist	" " and mileage	10.00

On motion Board adjourned sine die.

Attest
County Auditor

Joseph Lindquist
Chairman

CHARLES MIX COUNTY, SOUTH DAKOTA.

Commissioners Proceedings

Wheeler, S Dak April 1st 1913

The Board of County Commissioner's met in regular session with all members Present: Joseph Lindquist Chairman. Wm H Brazzell, Ed. Astin, H Haberna Auditor:

After the minutes of the last meeting were read and approved. the board. Convened. as a Board of assessment, at which meeting the assessors of ten townships were present.

The laws of assessment and taxation for the year 1913. was discussed Hon J. G. Jones, assessor for Signal township appeared before the Board. and presented the following resolution Where as:

The Constitution of the State of South Dakota limits the rate of taxation, and the basis of bonded indebtedness to a fixed amount of the assessed valuation and,

Where as: It was at the time of the framing of the Constitution, and for time immemorial thereto the established custom to assess property for the purpose of taxation in the same manner and upon the same basic values, and,

Where as: The Legislature at the late session did create a Tax Commission, and the said Tax Commission has taken step to secure an assessed valuation treble the customary basis for taxation and other purposes and.

Where as: This procedure will virtually treble the rate fixed by the Constitution violently arrogating powers not granted by the Constitution, and which if acceded to by all the counties of the state will deprive the people of the most sacred safe guards of the Constitution.

Therefore: Be it resolved; That we the Commissioners of Charles Mix County do hereby advise and direct the Assessors in and for Charles Mix County to assess all property as has been the custom and was the custom and long usage. When the Constitution was considered framed and adopted by the people of the State of South Dakota to the end that Charles Mix County shall not be a party to a dangerous and revolutionary evasion and abuse of the Constitution of the State of South Dakota.

The Board after carefully considering the same, upon motion ordered the resolution spread upon the record with the minutes of the meeting, and while the sentiment of the resolution was fully endorsed by the Board. favorable action could not be granted according to the provisions of the South Dakota Tax Commission Law: the same was therefore voted down.

COMMISSIONER'S RECORD, "3,"

Perkins Bros. Co., Printers and Binders, Sioux City, Iowa.

Clarence Hodgson, digging grave for child Wm Odgen Claimed \$7 ⁰⁰ Allowed	3.50
Geddes Mer. Co. Provisions for Co Poor. Boelter from Sept 24/12 to Feb 7/13.	57.35
Hammond & Stephens County Supplies	1.60
L. F. Phillips Milk Co Poor. Mrs Stastny	2.10
Rovraart Bros. Provisions	10.00
Geddes Mer. Co County Supplies	5.00
J. E. Craig Clerk's fee Mc Linn Case.	11.80
P. C. Roadefer - Atty fee By Order of Court State vs {Conrich Stastny Casper Stastny}	50.00
Floete Lumber Co Coal for Court House	13.15
Dr. R H Townsley. Phys. for Co Poor. Mrs Stastny	10.00
Com'l State Bank P. Court Certificates	18.10
John Kubal Bal. due Posting Registration List	3.00
H. C. Nordaker. Provisions for Co Poor K/Bobledyk.	10.00
J. E. Craig Fees for Feb term Court.	209.68
J. V. Murphy. Salary as Co. Supt. Jan 1st to Jan 9 - 1913	30.00
Missouri River Tel. Co. Tolls for County officers	8.75
A. Amundson Prov. for Co Poor. Schneider family	67.13
A. Amundson Mrs Cashman	38.81
J. H. Duceal & Co Coal Schneider family	9.40
M. Vaurineh Prov. Barney Sanders	20.00
A. T. Cole Desh. for Treas office	21.00
J. H. Duceal & Co. (P) Coal for Court House	106.85
C. F. Carroll Tolls for County officers	6.50
C. F. Carroll Postage Registrar of Deeds office	8.96
C. F. Carroll Clerk hire	111.80
Will C. Beach Ptg Co County Supplies	135.04

On motion the Depository Bond of Valley State Bank for County funds was approved.

On motion the Depository Bond of Ravinia State Bank for County funds was approved.

On Motion a refund of \$9.38 was allowed Herman Habel on 1912 taxes on account of erroneous assessment.

Refund order
516

On Motion County Auditor was instructed to issue refund order to K K Langeland Co Treas for 1912 taxes on N C 1/4 sec. 24-100-68 Tax receipt for same had been erroneously issued. said Tax was ordered to be reaccepted on tax list

On Motion petition of H. C. Schneider for abatement of 1912 taxes on Lots 490-479-489-488 sec. 15-94-63 was granted for the reason said land was not taxable for that year.

CHARLES MIX COUNTY, SOUTH DAKOTA.

On motion the following bills were allowed.

Mrs L. A. Rovaart	Nurse for Co-poor. Jensen Family	Claimed	85.00
Mrs. L. A. Rovaart	" " " " " " " "	Claimed 17.50 Allowed	10.00
Mrs S M Rhinehart	" " " " " " " "	" " 115.00	100.00
Mrs S M Rhinehart	" " " " " " " "	" " 105.00	85.00
Emma Rhinehart	" " " " " " " "	" " 85.00	75.00
A E Bossingham	Medicine	" " " " 109.80	75.00
A E Bossingham	" " Miss Shore.	23.80	18.00
A E Bossingham	" " Joe Kasper.		4.00
A E Bossingham	" " Frenchie		3.00
A E Bossingham	County Supplies		29.55
Dr. L D Cramblit	Phys for Co Poor. Fred Astin Jr.	Claimed 19.50 Allowed.	15.00
Dr L D Cramblit	" " " " Elza Wright	" 12.00	6.00
Dr L D Cramblit	" " " " James Savan	" 31.50	15.00
Dr L D Cramblit	" " " " Mike Goodness.		45.00
Dr. L D Cramblit	" " " " Henry Mader	Claimed 34.00 Allowed.	20.00

On motion the bill of Dr L D Cramblit Phys for Mrs French \$15.00 was tabled until next meeting.

On motion the following bills were rejected

Dr L D Cramblit	Phys. for Mr Frank.	7.50
" " " "	" " Chas Fry	12.50
" " " "	" " Chas. Blade.	14.50
" " " "	" " Wm Rock.	30.00
Dr E T Anderson	" " Chas H Flavell	32.75
Dr C C Day.	A. L Hagerman	103.50
" " " "	Carl Norgard.	72.00
" " " "	Bell Baker.	10.00
E H Beebe.	House Rent. Fred Williams	120.00
H. G. Wilson	" " Baker Family	24.00
J L Minahan	Anna B Mosher.	100.00

On motion the Board adjourned to meet April 3^d 1913.
April 3, 1913.

County Board met with all members + Auditor Present.

On Motion the County Treasurer. was instructed to redeem from tax sale Lots 11-12. Block 9. Lake Under said Church property being erroneously taxed.

On motion the petition of Chris Johnson for abatement of 1912 personal tax in Plaincenter township was ordered abated, for the reason said property was assessed in Kennedy township.

COMMISSIONER'S RECORD, "3,"

Perkins Bros. Co., Printers and Binders, Sioux City, Iowa.

On motion the letting of the Metal Culvert Contract, time was extended from 10, o'clock A M to 1, o'clock P M.

On motion the following bills were allowed.

Hammond & Stephens	County supplier for Co Supt	57.57
KK Langeland.	Postage for. Treas Office	50.00
J L Fredine	Provisions for Co Poor Jensen Family	7.29
J L Fredine	" " " Fred Williams	25.70
L B French.	Court Certificate	6.10
Carl Edberg	Board. for Poor. Oclar Guardin	91.00
The Wheeler Courier	County Printing	114.90
John Brunning	Court Certificate	4.70
W H McCall	Member Insanity Board. Case of Carl Norgard.	5.20
B H Reynolds	Mdse. for. Court House.	13.15
Bank of Seddes	Court Certificate	13.60
Lewis Jan	" "	4.70
Mitchell Pub. Co	County Supplies	97.35
G M Shuck.	Boarding Ed Ferris & holding him for sheriff	3.00
Brown & Saenger.	County Supplies	55.63
J E Craig	Postage Clerk of Courts office	10.00
H J Kaberna	Expense attending Auditors meeting at Pierre	26.20
H J Kaberna	Postage Auditors Office	11.85
Mrs Cyrus Danley.	Nursing Co poor. Jensen Family	7.50
L W Rizzle	Sheriff's fee for Quarter ending Mar 31/13	678.30
L W Rizzle	Jailors " " " " "	304.50
L W Rizzle	Cash expense for Prisoners for Quarter ending 3/31/13	12084
L B Fisher	Board. for Jurors.	9.00
M L Smith	Boarding Prisoners	33.90
E H Zuler	" " and Jury.	134.45
Carl Edberg	Room Rent. for Co poor. Kasper Family	10.00
Seddes Record	Printing for. Co Supt & Co Treas. office	28.25
Benj H Sanborn	Dal due on School text books.	4.93
Silver Burdett Co	" " " " " "	6.12

The following bids for Metal Culverts, for the ensuing year, were opened at 2 o'clock P M.

J H Lueal & Co.
 Hennepin Bridge Co.
 Illionois Steel Bridge Co
 Sioux Falls Metal Culvert Co.
 Berger. Mfg. Co.
 Thos W. Katheringham
 Russell Grader. Mfg Co

CHARLES MIX COUNTY, SOUTH DAKOTA.

On motion the Contract was awarded to J H Smeal & Co, Their being the lowest Bid, and it was ordered that the Contract for one year be entered into with said Company according to specifications, with their Bid, and at the following prices,

size inch	Gauge.	Price per foot.
9	16	\$.39
12	16	.50
15	16	.58
18	16	.73
24	16	.99
24	14	1.20
30	14	1.53
36	14	1.81
42	14	2.20
48	14	2.45
48	12	3.40
60	12	4.25
72	12	5.10

On motion petition for Steel Bridge across creek between sec. 32 and sec 5 in South Rouse Twp was allowed.

On motion petition for Steel Bridge across creek between sec. 9 and sec. 18 - Twp. 94 Range. 63 was allowed.

On motion petition for Steel Bridge across creek between lots 594 and lot 593 Twp. 94 Range. 63 was allowed.

On motion petition for improving and grading highway running west from the City of Wagner, along the township line between Bryan and Lawrence Townships, was allowed.

On motion petition for road along sections 8-18 and 19 Twp. 94 - Range 62 was referred to Wm F Brazzell for investigation.

On Motion petition for grading road on Choteau Creek between sec. 17 and sec. 20 Twp 95 range 62 was allowed.

On motion petition to establish road on the east line of sec. 9. and sec 16 Twp 94 Range 62 was referred to Wm F Brazzell for investigation

COMMISSIONER'S RECORD, "3,"

Perkins Bros. Co., Printers and Binders, Sioux City, Iowa

On motion petition for grading of road between sec. 34 Twp. 95 Range 62 and sec. 3 Twp. 94 Range 62, was referred to Wm H Brazzell for investigation.

On motion petition for grading of road between sections 32-33-34 Twp. 96 Range 62 and sections 3-4-5 Twp. 95 Range 62 was allowed.

On motion for Steel Bridge across Hunters Creek on sec. 11 Twp. 96 Range 65, was allowed.

Road Appropriation
Paid by Warrant
#11049 April 23/13

On Motion petition from Moore township asking for appropriation of \$2000.⁰⁰ to be expended on roads in Moore township was allowed at \$400.⁰⁰ Auditor was instructed to issue county warrant, for same payable to the Treasurer of Moore township

On motion petition for steel bridge across Platte Creek on section line running north and south between sec 22 and 23 Twp. 100 Range 67, was referred to Ed. Astin for investigation.

On motion petition to open highway between sec. 10 and sec 11 Twp. 99 - Range 68, was referred to Ed Astin for investigation

On motion petition for steel bridge across creek between sec. 35 and sec. 36 Twp 99 - Range 68, was allowed.

On motion petition for grading road to the approach of bridge between sec. 15 and sec 22. Twp 100 Range 70 was allowed.

On motion the Board adjourned to meet April 4th

April 4th 1913.

County Board met with all members and Auditor Present:

On Motion the following bills were allowed,	
C W Boyce Justice fees in Case of State vs Pat Mawhoney	Claimed 2.70 Allowed 1.95
A J. Macy " " " " State vs Spotted eagle	3.20
W T Harding Witness " " " " " " " "	1.10
H Hardman " " " " " " " "	1.40
G. S. Warren Justice " " " " State vs Wesley Mantagne	.65
G S Warren " " " " " " Clyde Jones	.65

CHARLES MIX COUNTY, SOUTH DAKOTA.

E H Robertson Justice fees in Case of State vs Ed Ferris	\$ 5.05
Julia Ferris Witness " " " " " " " "	1.50
Ed. Melmer " " " " " " " "	4.00
John Brunning " " " " " " " "	4.00
George Black " " " " " " " "	4.00
Hattie Archambeau " " " " " " " "	1.50
E W Boyce Justice fees in Case of State vs Roy Drapeau	3.45
S P Jewett Justice fees in Case of State vs Tom Vokes.	3.30
S P Jewett " " " " " " State vs John Doe	3.20
E W Curtis Justice fees in Case of State vs Ed Ferris Etl.	3.80
G M Shuch Marshall " " " " " " " "	4.00
E W Curtis Justice fee in Case of State vs Hattie Archambeau	3.30
E W Curtis " " " " " " State vs Henry Enger.	2.90
Vincent Kaberna Justice fee in Case of State vs Wm Kroycich	4.45
Wm Hinkley Constable " " " " " " " "	6.20
Frank La Rochelle Guarding Prisoner " " " " " " " "	3.00
Vincent Kaberna Justice fees in Case of State vs Staty Brois	1.55
Wm Hinkley Constable " " " " " " " "	11.30
Frank La Rochelle " " " " " " " "	9.00
Vincent Kaberna Justice " " " " " " " "	5.65
Harry Thompson Guarding Prisoners " " " " " " " "	2.00
John Stebronsky Interpreter " " " " " " " "	2.00
J F Nichols Justice fees in Case of State vs James Triplet	2.50
W C Coxon Deputy Sheriff " " " " " " " "	2.00
C. C. Day. Coroner's fees in Case of J. B F Johnson	20.50
Chas Meyer Jurors " " " " " " " "	1.10
Alfred B Wenzel " " " " " " " "	2.00
Louis Goldhammer " " " " " " " "	1.10
Ada F Johnson Witness " " " " " " " "	1.00
Roy Johnson " " " " " " " "	1.00
Henry Coch. " " " " " " " "	1.10
Wm Miller. Hauling water for Court house.	4.00
Platte State Bank. Court Certi	9.80

On Motion the assessment for the year 1912 on Lot 8 sec 28-99-66 was ordered corrected and 1st half tax paid by H Viken be refunded.

On motion the following bills were allowed,
 Ed. Ashin Perdiun Committee work and mileage \$ 28.80
 Wm F Brazzell " " " " " " " " 37.50
 Joseph Lindquist Perdiun and mileage 22.00

On motion the Board adjourned to meet April 22^d 1913.
 Attest
 F. Kaberna County Auditor
 Joseph Lindquist Chairman

Proceeding of the Board of County Commissioners

Wheeler, S. D. April 22, 1913

Board of County Commissioners met pursuant to adjournment taken April 4th 1913. Present Joseph Lindquist Chairman, Wm F Brazzell, Ed. Astin, J. Kaberna. Auditor

Petition of West Howard School District,

On now on this 22nd day of April, 1913 being a day of the regular April meeting of the Board of County Commissioners of said Charles Mix County, Mrs. Cora E. Stone County Superintendent of Schools of said County met with the said Board and the said Board and said Superintendent of Schools having under consideration the matter of the Division of West Howard School District in said County, proceeded to examine the proceeding relating thereto on file in the office of County Auditor, and it appearing that said proceedings are in all respects according to law; that in pursuance of a petition duly filed containing the required number of signatures, and after due notice legally given, and election was held in said district and at said election it was duly and lawfully determined that said district be divided in accordance with said petition and the plat accompanying same.

Now therefore upon motion duly made and recorded, which motion unanimously carried, it is ordered that the said West Howard School District be divided in accordance with the said petition and plat, and the return of said petition and the election aforesaid. And it is further hereby ordered that four independent school districts be created and established from the territory and lands here to fore embraced and included in said West Howard School District, said new districts to be described and bounded as follows, to-wit:

School District No 1.

Embracing the following sections in Township 97 Range 64 West Howard School District South half section 18 South half section 17 and fractional parts of South half section 16 all section 19 all section 20 Lots 1-2-3 in section 21 All lands embraced in sections 30 Lots 1-2-3 in section 29. All lands embraced in section 31 The above described section and part section constitutes School District No. 1

School District No 2.

In Township 97. Range. 64 West Howard School District South half section 6, south half section 5 south half section 4

CHARLES MIX COUNTY, SOUTH DAKOTA.

all section 7-8-9 Lots 3-4-5 and 6 in section 16, north half section 17 north half section 18, all section and part section described here constitutes School District No. 2.

School District No 3. In township 97 Range 64 West Howard. School District, north half section 4, north half section 5, north half section 6 (Township 98 Range 64 all sections 31-32 and 33, south half section 30 south half sections 29, south half section 28 to constitute District No 3.)

School District No 4 West Howard School District Township 98 Range 64 north half sections 28, north half section 29, north half section 30 all section 19, South half section 20 Lots 3-4-5 in section 20, Lots 5-6-7 and 8 in section 21, Lots 6-7-8 and 9 in section 18 To constitute District No 4

A plat of said division showing boundaries is affixed to this petition.

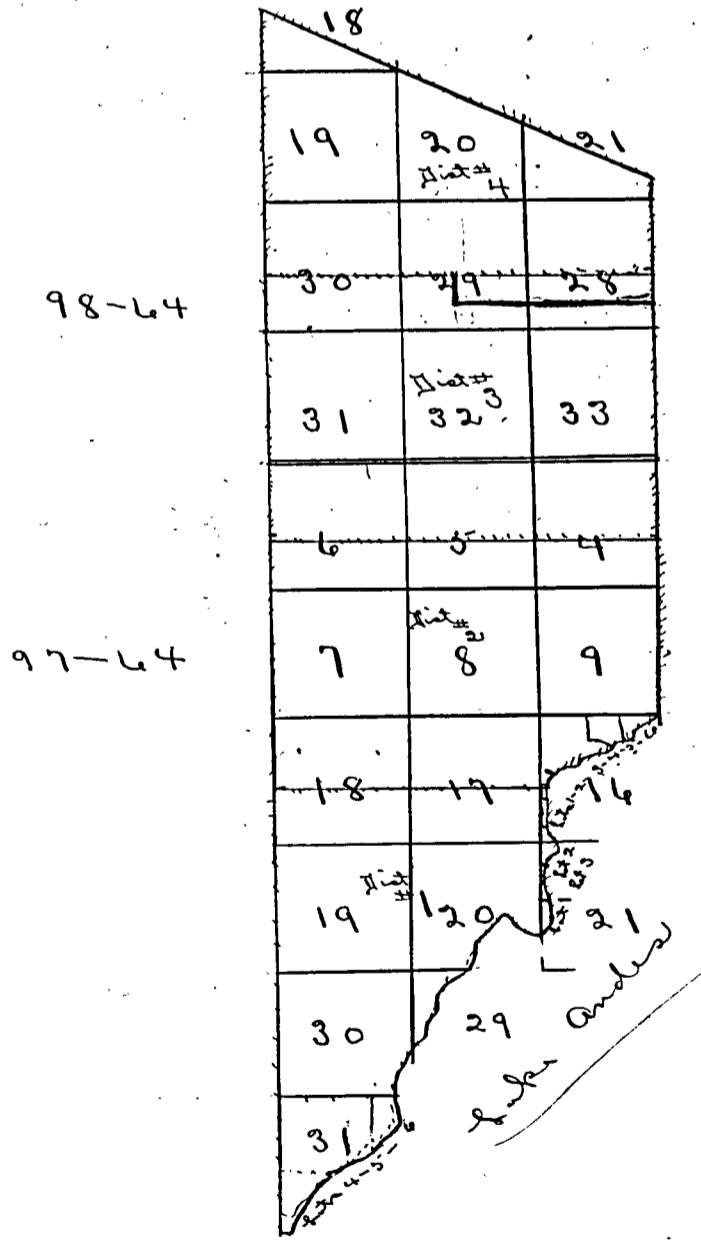

West Howard School District
Charles Mix County South Dakota
Showing Proposed Division into
two independent Districts.

Approved by the Board of
County Commissioners.

April 22nd 1913

COMMISSIONER'S RECORD, "3,"

Perkins Bros. Co., Printers and Binders, Sioux City, Iowa

States Attorney Beck, J. T. Caspell and W. H. Menzel appeared before the Board and asked for an appropriation to assist in paying attorneys fees E. C. Wagner and G. M. Castor having been employed by them to assist the States Attorney in the prosecution for violations under the 1909 anti-trust act. On motion the Board directed the Auditor to draw a warrant in favor of E. C. Wagner for \$250.⁰⁰ and another to G. M. Castor for \$100.⁰⁰ for such assistance.

On motion the bill of Mark Cambell was allowed.
 Co. Poor
 Carey Jensen Family

26.50

On motion the application of Edwin Phillips for refund on 1911 Personal tax City of Geddes erroneously assessed was allowed.

On motion the application of Sus. Busche for refund on 1911 personal tax of Ray Lyons, erroneously included in tax sale was allowed. said tax of Ray Lyons was ordered re-extended on 1911 tax list

On motion the application of Farmers Co-operative Elevator Co. Geddes for a partial refund on 1911 tax was allowed.

On motion application of T. C. Andrews for abatement on valuation of \$1000.⁰⁰ on 1910 personal property tax. Lake Under erroneously placed on assessment roll was allowed.

On motion the penalty and interest on the personal tax of C. M. Elliott for ^{the} year 1890, was ordered abated

On motion the application of L. L. Davis Secretary, Masonic Temple Company, for a partial refund of \$9.92 on 1912 Personal property tax, City of Geddes erroneously assessed was allowed.

On motion Auditor was instructed to issue refund order ^{for \$10.64} to K. K. Langeland, Co. Treas. for 1912 Taxes on Lot 4, sec 5-96-65 tax receipt for same had been erroneously issued.

On Motion the Depository Bond of Platte State Bank was approved.

On Motion the petition from Highland Township, asking for an appropriation of \$300.⁰⁰ to grade road to County Bridge between sections 27 and 34 Township 95 Range 64 was allowed.

CHARLES MIX COUNTY, SOUTH DAKOTA.

On motion petition for steel bridge across creek. Between sections 4 and 5 Township 95 Range 64 also an appropriation of \$500.⁰⁰ To grade road between said sections and running south 6 miles was allowed.

On motion petition for steel bridge across Pease Creek. in section 29. Township 98 Range 66. was allowed.

On motion petition for steel bridge across creek. Between sections 19 and 20 Township 96. Range 65. was allowed.

On motion petition for steel bridge across creek. Between sections 19 and 30 Township 96 Range 65. was allowed.

On motion petition for steel bridge across Snake Creek. Between sections 15 and 22 Township 100 Range 70. was allowed.

On motion petition for steel bridge across creek. Between sections 29 and 32. Township 97 Range 66. was allowed.

On motion petition for steel bridge across creek. Between sections 5 and 6. Township 96 Range 63. was allowed.

On motion the bill of Bon Homme County for \$3041.99 amount alleged due from Charles Mix County for bridge work on County line was referred to Commissioner Brazzell for investigation, with instructions to report at the next regular meeting

On Motion petition from the supervisors of Hamilton Township, for the grading of an established highway, some five miles in length in said district was allowed.

On motion petition of Frank Rehurek and other of Bon Homme County to locate & establish a public highway on County line between sections 30-95-61 and Lot 6 and 7, section 19-95-61, was referred to Commissioner Brazzell for investigation and to report at the next regular meeting

COMMISSIONER'S RECORD, "3,"

On motion petition of John Sundall and others to establish public highway on County line between Charles Mix County and Douglas County was referred to Commissioner Lundquist for investigation and to report at the next regular meeting

On motion the bill of Mrs. Rowgart, Danley and Minehart for washing for County poor Jensen family \$48.00 was rejected
 On motion the bill of A. L. Nichols' Perdiem & mileage in Harben disbarment case \$44.00 was rejected

On motion the following bills were allowed.

Platte State Bank. Court Cert [#] 1499	15.10
" " " Witness " # 819	2.10
" " " Court " # 832	15.10
" " " Witness " # 821	2.10
" " " " " # 820	2.10
Platte State Bank. " " # 849	3.00
Security State Bank. Court " # 1481	14.00
" " " " " # 844	7.50
Com'l State Bank (P) " " # 837-842.	18.20

On motion board adjourned to meet April 23,

April 23, 1913.

County Board met with all members, and Auditor Present.

On motion the following bills were allowed.

Geo. B Siddons Mdse Co Poor. Fred Williams	4.75
S. C. Graf " " " " " "	1.00
Missouri River Tel. Co. Tolls for Co. Officers Murphy and Ruffe	32.75
W. H. Farmer. House Rent Co Poor. Mike Goodner. Claimed 45.00 allowed.	36.00
Farmers Cooperative El. Co Wagner Coal for Co Poor. Stastny and Cade	15.10
J. E. Craig Clerks fees Case of State vs Ferris	11.20
Cora C. Stone Office expense for quarter	139.92
Mrs L. A. Rowgart. Nurse Co Poor. Jensen family	100.00
Dr. P. R. Pinard. Physician Co Poor. Terry. Claimed 122.00 allowed	85.00
Frank Horah. House rent Co Poor. Stastny	7.50
J. E. Craig Clerks fees State Cases.	19.50
Dr. F. M. Blezek. Physician Co poor Stastny	7.00
Educator School Supply Co County supplies	73.70
Williamson Bros Mdse for Co Poor. Wm Dodd.	30.00
J. E. Craig Clerks fees Case of State vs Hecherman	2.70
Burroughs Adding Machine Co. Bal due on adding machine	300.00
W. A. Lathrop. Board of Registration Jackson trip	3.00
Mrs S M Minehart Work for Co Poor. Jensen family Claimed 35.00 allowed	24.00
Emma Minehart " " " " " "	10.00
John Geusebrack. Mdse " " " " " "	5.35
M Vaurined. Provisions " " " " " "	10.00
Rowgart Bros " " " " " "	10.00

CHARLES MIX COUNTY, SOUTH DAKOTA.

Will. A. Beach Printing Co	County supplies	88.85
H. K. Engel.	Meat for Co Poor. Schneider family	27.40
H. J. Haberna.	Postage and express	18.47
Chas Mix Co Bank.	Court Certificate #845	7.00
Ed. Astin.	Committee work. Per diem & mileage	37.40 ⁰
Wm H Brazzill	" " " "	26.00 ⁰
Joseph Lindquist	" " " "	14.00 ⁰

On motion the Board adjourned to meet May 27th 1913.

Attest H. J. Haberna

County Auditor

Chairman

Proceedings of Board of County Commissioners
Wheeler S. Dak. May 27th 1913

Board of County Commissioners met pursuant to adjournment taken April 23, 1913 Present Joseph Lindquist Chairman

Ed. Astin, W. H. Brazzill and H. J. Haberna Auditor.

The Bids for the letting of highway grading, were opened and examined by the County Board.

After due consideration the Board in motion rejected all bids that were filed. The County Auditor was instructed to re-advertise for new bids and to place the time of letting July 1st 1913 at 2 o'clock P.M.

On motion the petition of the residents of Howard Township for an appropriation of \$500.00 for road improvements on highway running North and South between sections 8 & 9 and 16 & 17. Township 97. Range 64, was granted.

On motion the following bills were allowed:

A. B. Beck.	Expense States Attorney office	34.50
Warren Barada	Deputy Sheriff Fees.	118.50

C. H. Carroll	Postage & Expense	12.11
C. H. Carroll	Clerk here for month April	42.90
W. H. Brazzill	Per diem Committee work & Mileage	46.00
Ed Astin	" " " "	22.80
Joe Lindquist	" " " "	24.75

On motion the Board adjourned to meet June 20th 1913

Attest:

H. J. Haberna

County Auditor

Chairman

COMMISSIONER'S RECORD, "3,"

Proceedings of The Board of County Commissioners
Wheeler, S. Dak. June 20th 1913

Board of County Commissioners met pursuant
to adjournment taken May 27th 1913 Present Joseph Lindquist
Chairman, Ed. Astin, F. J. Kaberna, Auditor and W. H. Brazile Absent.

The Clerk of Courts filed the following request:
To the Honorable Board of County Commissioners of
Charles Mix County,
You are hereby requested to extend the jury list to 200
names, by adding 12 names.

Yours respectfully
J. B. Craig,
Clerk of Courts

The Board proceeded to comply with the above request
and the following names were chosen to keep the 200 names
of the jury list intact:

Konrad Klein	Choteau Creek Township
Alfred Lien	Darlington "
Frank Hobbs	Howard "
T. S. Selvids	Highland "
Sam L. Davis	" "
Holst De Jong	Platte "
W. H. Fowler	City of Geddes
Merton Davis	" " Platte
L. M. Holmes	" " "
V. J. Pesicka	" " Wagner
Thos. Cole	" " "
Otto Porcutch	Town of Ravinia

The application and Bond of Burt Null and Frank O'Connor, as
Co-partners under the firm name of Null and O'Connor, to sell
intoxicating liquors at retail in the building located on Lot 11
Block 13, City of Platte, Charles Mix County, South Dakota, was
considered by the Board, and in motion the application was allowed
and the bond approved. And the County Treasurer, was directed
to, upon payment of the proper license fee, to issue license and
permit to said applicants, as provided by law.

The application and Bond of Martin Schroeder and Elden Taylor,
as Co-partners under the firm name of Schroeder and Taylor, to sell
intoxicating liquors at retail, in the building located on Lot 18 Block 21
City of Platte, Charles Mix County, South Dakota, was considered

CHARLES MIX COUNTY, SOUTH DAKOTA.

By the Board, and on motion the application was allowed and the Bond approved, and the County Treasurer, was directed to upon payment of the proper license fee, to issue license and permit to said applicants, as provided by Law.

The application and Bond of John Crowley and F. E. Nicholson, as Co-partners under the ^{firm} name of Crowley and Nicholson, to sell intoxicating liquors at retail in the building situated on Lots 17 and 18 Block 16. City of Geddes, Charles Mix County, South Dakota, was considered by the Board, and on motion the application was allowed, and the Bond approved, and the County Treasurer was directed to, upon payment of the proper license fee, to issue license and permit to said applicants, as provided by Law.

The application and Bond of Joseph Musilek and Roy Kitterman, Copartners under the firm name of Musilek and Kitterman, to sell intoxicating liquors at retail in the building situated on Lot 11, Block 10. City of Geddes, Charles Mix County, South Dakota, was considered by the Board, and on motion the application was allowed, and the Bond approved, and the County Treasurer was directed to, upon payment of the proper license fee to issue license and permit to said applicants, as provided by Law.

Road Appropriation
Lake Andes.
Issued by
CMT #1412

On motion the petition from the Citizens of Lake Andes, asking for an appropriation of \$500.00, in constructing a road on the south side of Lake Andes on section 9-96-65 was granted the Auditor instructed to issue warrant. Payable to the Treasurer of the City of Lake Andes.

On motion the County Treasurer was authorized to transfer the unexpended ^{Balance} in the Fish Fund. To the Game Fund.

On motion the Standard Bridge Company, was allowed \$12000.00 as first estimate on Bridges and Material on 1913 Contract.

On Motion the following bills were allowed.

M. L. Smith	House rent for County Poor Williams	2000
S. C. Graf	Provisions for " "	500
Warren Barada	Deputy sheriff fees.	207.85
F. Haberna	Postage & express	15.25

Continued next page.

COMMISSIONER'S RECORD, "3,"

Perkins Bros. Co. Printers and Binders, Sioux City, Iowa.

Joseph. Lindquist	Per-dium, Committee Work & mileage	19.00
Ed. Austin	" " " " " " " "	42.50

On motion the Board adjourned without day.

Attest:

F. J. Kaberna
County Auditor

Joseph. Lindquist
Chairman

Proceedings of Board of County Commissioners
Wheeler S. Dak. July 1st 1913.

The Board of County Commissioners met as a Board of Equalization, Present: Joseph. Lindquist, Chairman, Ed. Austin, F. J. Kaberna, Auditor, Absent: W. F. Brazzell, The assessors. Books not being all filed, the Board adjourned as a Board of equalization, until July 7, and proceeded as a Board of County Commissioners.

The sealed bids on file for the grading of certain bridge approaches and roads, were opened and examined by the County Board, and on motion contracts were awarded to the lowest bidder as follows,

Frank. Haney, Grading of bridge approaches on east and west sec. line between sec. 5, 95-63 and sec 32, 96-63
Total 3822 cubic yards at 17 cts per cu. yd.

Frank Haney, Grading of bridge approaches on east and west sec. line between sections 19 and 20 - 95-62,
Total 1200 cubic yards @ 21 cts per cu yd.

Frank. Haney, Grading of bridge approaches on ditch on east and west section line between sections 17 and 20 ^{sec 95-62}
Total 1200 cubic yds. @ 21 ct per cu yd.

Thos. Harney and Ed. Bradley, Grading of bridge approaches on east and west section line between sections 27-34, 95-64
Total 1600 cubic yards @ 17 cts per cu. yd.

~~Thos. Harney~~ ^{Rhin and Denoma} and Ed. Bradley Grading of roadⁿ north and south section line, between sections 4-5-95-64.
Total 1000 cu. yds. @ 15 per cu. yd.

Continued next page

CHARLES MIX COUNTY, SOUTH DAKOTA.

- Ed Rhein and Frank Denoma, Grading of road running south from section 5 to smooth into good shape as far as \$300. will go Bid per rod. 30 cts
- 7 Thos Harney and Ed Bradley, Grading of bridge approaches on east and west section line, between sections 5, 95-62 and section 32, 96-62, 1200 cubic yards. @ .20 per cu. yd.
- 8 Thos. Harney and Ed. Bradley, Grading of bridge approaches on east and west section line, between sections 3, 95-62 and section 34-96-62, 800 cubic yards, @ .20 ct. per cu yd.
- 9 Ed Rhein and Frank Denoma, Grading of road on east and west section line, between sections 19-20, 96-65 Total 8200 cubic yards. @ .24 cts per cu. yd.
- 10 Thos Harney and Ed Bradley. Grading of bridge approaches 1 mile north and 1 1/2 miles west from academy in La Roche Township, 2100 cubic yards @ 30 ct per cu. yd.

J. F. Spotts, Grading of road on north and south section line, between sections 8-9, 97-64, 4200 cubic yards. @ 18 ct per cu yd.

On motion the bids for grading of bridge approaches, Platte Creek, bridge, near mouth, in Hamilton township 800 cubic yards and cut about 1/2 mile east of Platte Creek, bridge, Hamilton township, 1000 cubic yards, were rejected, and Commissioner Actin, was authorized to have said grading done under his supervision.

On motion petition for steel bridge, across creek, between sections 3 and 6, 96-65, was allowed.

On motion it was ordered that the contract work of Ellerman, McLain Construction Company, in excavating and constructing Brown Bear Lake Drainage ditch in Moore Township, in said County be accepted, that a warrant for 489.45 appropriated by the State of South Dakota, for the construction of said ditch, be issued to said Construction Company, said warrant covering assessment on NW 1/4 of NE 1/4 section 16, 98-66, and that Special assessment Certificates be issued for the balance of the contract price for said ditch in accordance with the previous proceedings had in relation thereof.

Continued next page.

COMMISSIONER'S RECORD, "3,"

Perkins Bros. Co., Printers and Binders, Sioux City, Iowa.

The Application and Bond of T. J. Devaney, to sell brewed and malt liquors at wholesale (only), in the building situated on Lot 5 Block 22, City of Platte, Charles Mix County, South Dakota, was considered by the Board, and on motion the application was allowed, and the bond approved. The County Treasurer, was directed to upon payment, of the proper license fee, to issue license, and permit to said applicant, as provided by law.

On motion the following bills were allowed.

Ellerman, McLain Construction Co. for labor on Brown Bear Lake.		
Drainage project		33.00
Western Engineering Co. for surveying County Roads.		302.95
Thos. McCabe	Assessing Bryan Twp.	84.00
J. H. Jordan	" Plain Center "	84.00
J. M. Stone	" Kennedy.	84.00
C. D. Sadler.	" Lawrence	80.00
S. T. Hansen	" Darlington	85.00
J. W. Drorah.	" White Swan	143.00
A. C. Cochran.	" City of Wagner.	156.00
L. C. Tutley	" " " Platte	174.00
A. B. Besh.	Expense Account.	6035
C. E. Smith	Witness Certi # 856	7.20
G. H. Patrick	Court " # 8	3.10
Commercial State Bank. (P)	" " # 4	3.20
Bank of Geddes.	Witness " # 857	7.20
Platte State Bank.	Court " # 850	23.00
Lakeside " "	Witness " # 619	2.40
Char. Mix Co. " "	" " # 854	7.50
Commercial State Bank.	" " # 1483	10.50
First State Bank.	Court " #	59.70
Chas. Mix Co. Bank. (P)	" " # 853	21.20
Chas. Mix Co Bank.	" " # 861	3.30
J. C. Miller	Duplicate warrant # 10355-10360	11.70
Frank Kosel	Labor on roads Rouse twp	20.00
J. W. Jonas.	" " " " "	8.00
J. W. Bush.	" " " " "	4.00
John Frederick	" " " " "	4.00
Frank Klaucek.	" " " " "	4.00
Ellerman, McLain Construction Co. Drainage assessment on NW of NE sec 16-98-66		489.45
County Seat State Bank. Court Certi		68.80

CHARLES MIX COUNTY, SOUTH DAKOTA.

Joe Lindquist, Cash paid for railroad fare for Lottie Thompson,	(Co Poor)	103.65
J. E. Craig, Vital statistic reports.		50.00
J. E. Craig Fees. Clerk of Court		334.60
J. E. Craig " " "		10.40
J. G. Jones. Assessing Signal Twp		75.00
Ed. Austin Peddium-Committee work - mileage		25.00
Joe Lindquist " " " "		23.60

On motion the Board adjourned to meet July 9th 1913

Attest

H. Haberna

County Auditor

Joseph Lindquist

Chairman

Proceeding of Board of County Commissioners Wheeler, S. D. July 7th 1913

The Board of County Commissioners met as a County Board of Equalization, pursuant to adjournment taken July 1st 1913. Present Joseph Lindquist, Chairman Ed Austin Auditor Absent Wm. Brazzell

The Board proceeded to examine the assessment rolls of the several townships.

On motion Board adjourned to meet July 8th 1913.
July 8th 1913.

Board met as per adjournment, with same members present, and continued with the examination of the assessment rolls.

The application of Jacob Olsen, of Platte, S. D., asking the County Board of Equalization to strike from the assessment roll of Forber Township 900 head of Cattle assessed to him and valued, by the assessor at \$8000.00, after being duly considered, was on motion rejected.

On Motion Board adjourned to meet July 9th 1913.
July 9th 1913.

Board as per adjournment, with same members present and continued, with the examination of the assessment roll.

On motion Board adjourned to meet July 10th 1913

COMMISSIONER'S RECORD, "3,"

July 10th 1913.

Board met as per adjournment, with same members present, and continued with the examination of the assessment rolls.

On motion Lands, Lots and Structures in the several Cities, Towns and Townships, were equalized as follows:

		Values of Land.	Structures
Bryan	Township	Raised 15%	Raised 25%
Carroll	"	" 10%	" 300%
Castalia	"	No-Change.	Lowered 65%
Choteau Creek	"	Lowered 28%	Lowered 60%
Darlington	"	Lowered 5%	Lowered 60%
Horbes	"	Raised 15%	Raised 100%
Goose Lake	"	Raised 5%	Raised 20%
Hamilton	"	Raised 20%	Raised 100%
Howard	"	Raised 25%	Raised 200%
Highland	"	Raised 37%	Raised 400%
Jackson	"	Raised 40%	Raised 100%
Kennedy	"	Raised 15%	Lowered 25%
Lake George	"	Raised 15%	Raised 400%
La Roche	"	Lands Graded } A. Raised 65% B. Lowered 20% C. No-Change.	Raised 500%
Lawrence	"	Raised 25%	Raised 20%
Lone Tree	"	Lowered 23%	Raised 400%
Moore	"	Raised 10%	Raised 40%
Plain Center	"	Raised 13%	No-Change
Platte	"	Raised 10%	Lowered 65%
Ree	"	Raised 24%	Raised 50%
Rhoda	"	No-Change	Lowered 60%
Rauze	"	No-Change	Lowered 60%
Signal	"	Raised 10%	Raised 50%
Wahehe	"	No-Change	Lowered 50%
White Swan	"	Lowered 15%	Lowered 20%
City of Platte		Lowered 5%	Lowered 30%
City of Seddes		No-Change	No-Change
City of Wagner		No-Change	No-Change
City of Lake Andes		Raised 30%	No-Change
Town of Ravinia		No-Change	No-Change
Town of Dante		No-Change	No-Change

On motion Board adjourned to meet July 11th 1913

CHARLES MIX COUNTY, SOUTH DAKOTA.

July 11th 1913.

Board met pursuant to adjournment, with same members present, and proceeded to examine the personal assessment rolls.

On motion Board adjourned to meet July 12th 1913

July 12th 1913.

Board met pursuant to adjournment with same members present.

On motion the Board adjourned as a Board of equalization until July 14th 1913, and proceeded as a Board of County Commissioners

On motion the following bills were allowed:

L.W. Ripple,	Sheriff fees, for quarter ending June 30 th	492.90
L.W. Ripple	Jailors " " " " " "	245.50
L.W. Ripple	Cash expended for Prisoners " " " "	58.13
Frank Junek.	Assessing Choteau Creek. Twp.	129.80
Geo R Cole.	" Carroll. " " "	62.50
George Boyesen	" Castalia " " "	77.50
Harry Plath	" Horber. " " "	69. ⁰⁰
Jacob Jacoby.	" Goose Lake. " " "	145. ⁰⁰
B L Seese	" Hamilton " " "	42. ⁶⁰
David Williams	" Highland " " "	78. ⁰⁰
J R. Baird	" Howard. " " "	109.50
Jos. A. Palvir	" Jackson " " "	144.00
Andrew Nelson	" La Roche " " "	75. ⁰⁰
H. J. Perek.	" Lake George. " " "	61.50
J H Finche	" Lone Tree " " "	78. ⁷⁰
Peter Indahl.	" Moore " " "	125. ²⁰
Cornelius Oly.	" Platte " " "	72. ⁰⁰
W.G. Blair	" Rhoda " " "	100. ⁰⁰
John Nedved.	" Ree " " "	125. ⁰⁰
W. J. McCormick	" Raure ^{and} Wakehe " " "	189. ⁰⁰
H D Loreng.	" Town of Dante " " "	40. ⁸⁰
L. J. Radcliff	" City of Lake Ander. " " "	145. ⁰⁰
W. H. Minahan	" City of Seddes. " " "	154. ⁵⁰
Dak. Central Tel Co.	Tolls for Sheriff	18. ⁰⁵
U J Walsweer.	Repairing, Iron Beds for Jail	11. ⁷⁵
C T Liles.	Boarding Prisoners.	88. ⁰⁰
The Platte Tribune	County Printing	56. ⁷⁵
Chas Mix Co News.	Printing for County officers	17. ³⁵
Lake Front Booster	Printing for Board of Health	7. ⁴⁰
Capital Supply Co	Supplies for County Supt.	44. ⁵⁵
Cora E. Stone	Mileage to Pierre, Co. Supt meeting	23. ⁷⁹

COMMISSIONER'S RECORD, "3,"

Record. Printing Co.	Printing for Co. Supt.	20.50
J. E. Bell,	Supplies for Court House	8.80
Coal. Bros	" for County	8.00
Wagner. Post.	County Printing	139.33
Educator School Supply Co.	Supplies for Co. Supt.	12.50
Capital Supply Co.	" " " "	52.72
News. Printing Co.	County Supplies	36.57
Educator School Supply Co.	Supplies for County Institute	22.85
Brown & Saenger.	" for County	95.25
C. S. Baten	Serving of jury. Claimed 4 ⁷⁰ Allowed.	3.70
Wm Miller	Water for Court House	6.50
J. H. Nichols	Fee " " "	37.50
Yankton County.	One half expense of joint Institute held at Yankton	540. ⁰⁰
Lillian C. English	Stenographer Feb term of Court.	201.40
H. C. Nordaker & Co.	Provisions for Co-poor. Bobledyk.	30. ⁰⁰
M. Vaurinek	" " " Lancrean	30. ⁰⁰
G. F. Buche & Co	" " " Mrs Thompson	39. ¹²
O. L. Nicolls	Medse " " Schneider	30. ⁰⁰
J. L. Fredine	" " " Fred Williams	38. ³²
Frank Horak.	House Rent " " Stastny	18. ⁷⁵
Carl Edberg	Board " " Frenchie	20. ⁰⁰
Farmer's Co-op Co. (L. A)	Coal. " " Schneider	44. ⁶⁰
W. E. Price,	Medicine " " Stastny & Lancrean	21. ²⁰
M. J. Janda	Medse " " Mrs Kade	30. ¹⁷
Farmer's Association (Dante)	Coal " " " "	5. ⁸⁰
Rovaart Bros	Medse " " Stastny	10. ⁰⁰
Farmer Co-op Co. Wagner.	Coal " " Stastny, Kade, Lancrean	14. ⁷⁵
C. H. Shay.	Medse " " Mrs Kade	50. ⁶⁰
Char Mix Co Farmer Assn (Platte)	Coal " " Fred Williams	10. ⁶⁰
B. H. Reynolds,	Supplies for Court House	8. ³²
Lawrence St Marie,	Typewriting for States Atty	10. ⁰⁰
Will A. Beach Ptg Co	Supplies for County Claimed 457 ⁴⁵ Allowed	400. ⁰⁰
Educator School Supply Co.	" " Co-Supt.	11. ⁹⁰
" " " "	" " " "	16. ³²
Mitchell Publishing Co.	" " Co Judge	10. ⁶²
P. C. Miller	Burymd deceased horse By order of Board of Health	10. ⁰⁰
Christoph Weisz	Casket for Co Poor. Johnson Claimed 63 ⁰⁰ Allowed	40. ⁰⁰
J. E. Craig,	Postage	22. ⁰⁰
J. E. Craig,	Filing transcripts State Cases.	20. ⁷⁵
Isaac Piles	Witness Certificate	10. ⁹⁰
Char. Carroll	Cherk hire for May and June	69. ⁰⁰
Char. Carroll	Postage	15. ¹⁶
Char Carroll Agent for.	D. C. Tel Co, Tolls for Co-officers.	9. ⁴⁰

CHARLES MIX COUNTY, SOUTH DAKOTA.

NK Langeland	Postage	30. ⁰⁰
J H Dmeal & Co	Grade stakes Claimed 7. ⁰⁰ Allowed.	5. ⁰⁰
F. E. Frye.	Physician for Co-poor. Mrs Breech.	
	Claimed \$210. ⁰⁰ Allowed.	160. ⁰⁰
F. E. Frye	Physician for Co-poor. Isaac Johnson	10. ⁰⁰
F. E. Frye.	" " " L. Archauban	12. ⁰⁰
P R Pinard	" " " Sanders, Made, Johnson	
	Claimed 39. ⁵⁰ Allowed.	30. ⁰⁰
Educator School Supply Co	Supplies for Co-Supt.	2. ⁷⁵
" " " "	" " " "	11. ³⁰
John Kreitle	" for County.	15. ⁸⁵
John Stedronsky	" " Wabeko Twp.	1. ²⁵
Florence Brazzill	Taking testimony Case of State vs Valenta	6. ⁴⁰
Rand McNally Co.	School Text Books.	23. ⁹¹
Educational Publishing Co.	" " " "	3. ³⁴
Ginn & Co.	" " " "	99. ²⁵
American Book Co.	" " " "	195. ⁴⁸
R P Frink.	Quarantine Heil Family	10. ⁰⁰
P R Pinard	" & Disinfecting Heil.	
	Brodsky, Stevens Brodsky School House	35. ⁰⁰
J. A. Seapy,	Quarantine & Disinfecting	59. ⁵⁰
H F Stuart	" Ed Bradley Family	10. ⁰⁰
R H Townsley	" Coffman & Heil "	20. ⁰⁰
J. A. Seapy.	Attending meetings of Board of Health	6. ⁵⁰
H A Reichman	Disinfecting premises of Goodman and	
	Speakman for Ganders.	20. ⁰⁰
H A Reichman	Investigating death of domestic animals	
	on Snake Creek. Claimed 35. ⁰⁰ Allowed	25. ⁰⁰
Wagner Drug Co.	For. Disinfectants	3. ⁹⁰
L. J. Radcliff	Burying dead. Girl at Lake Andes.	15. ⁰⁰
A B Reck.	Attending meeting of Board of Health	1. ⁵⁰
Chas Meyer.	Care of Co-poor. B F Johnson	5. ⁰⁰
Jas E. Puffing	Material, painting papering for Court House	
	Claimed \$165. ⁸⁰ allowed.	145. ⁰⁰

This list was returned & cancelled Aug 11th 1913

Warrant # 11250

On motion it was ordered that Cora E Stone, County Supt. and Joseph Lindquist Commissioner, act as a Committee, to divide the property of West Howard School District, to complete the order to divide the school district, into four independent School Districts.

On Motion Board adjourned to meet July 14th 1913

COMMISSIONER'S RECORD, "3,"

Perkins Bros. Co., Printers and Binders, Sioux City, Iowa.

July 14th 1913.

The County Board of Equalization met pursuant to adjournment taken July 12th 1913 Present Joe Lundquist Ed Astin, F. Haberna

Board. continued the examination of the personal assessment rolls.

On motion the Board adjourned to meet July 15th 1913

July 15th 1913

Board met as per adjournment, with same members present.

On motion, assessments, on personal property in the several Townships, Towns and Cities were equalized as follows:

Bryan Township, Values on "A" Horses, lowered. 23%
"B" Horses, lowered. 4%; "C" Horses, raised 115%; "A" Cattle, No-Change; "B" Cattle, raised 20%; "C" Cattle, raised 15%; Mules No Change; Hogs, raised 40%; Wagons, No Change; Automobiles, raised. 264%; Pianos, raised 210%; Machinery, raised 150%

Carroll Township, Values on "A" Horses, raised 8%; "B" horses, lowered. 6%; "C" horses, raised 400%; "A" Cattle lowered 40%; "B" Cattle, lowered 15%; "C" Cattle, lowered. 25%; Mules, raised 25%; Hogs, lowered 40%; Wagons, lowered. 20%; Automobiles, raised. 6%; Organs, No-change; Pianos, raised 100%; Furniture, raised 30%; Machinery, raised 700%.

Castalia Township, Values on "A" Horses, lowered 36%; "B" Horses, No-change
"C" Horses, raised 25%; "A" Cattle lowered 34%; "B" Cattle, lowered 25%; "C" Cattle, lowered. 30%; Mules, lowered. 25%; ^{Hogs lowered 40} Organs, lowered 15%; ^{Wagons lowered 10} Pianos, lowered 31%
Furniture, lowered 65%; Machinery, raised 30%.

Choteau Creek, Township, Values on "A" Horses, lowered. 40%; "B" horses, lowered 28%; "C" Horses, raised 80%; "A" Cattle, lowered 23%; "B" Cattle, lowered. 14%; "C" Cattle, no-change; Mules, lowered 5%; Sheep, No-change; Hogs, lowered. 36%; Wagons, lowered. 20%; Automobiles, lowered. 50%; Organs, lowered 45%; Pianos, No-change; Furniture, lowered 50%; Machinery, lowered 50%.

Darlington Township, Values on "A" Horses, lowered 6%; "B" Horses, lowered 8%; "A" Cattle, lowered 32%; "B" Cattle, No-change; "C" Cattle, raised 9%; Mules, lowered 12%; Sheep, raised 20%; Hogs, lowered 30%; Wagons, raised 18%; Automobiles, lowered. 43%; Organs, raised 66%; Pianos, lowered 18%; Furniture, No-change; Machinery, raised 150%.

CHARLES MIX COUNTY, SOUTH DAKOTA.

Forbes Township, Values on "A" Horses, lowered 34%; "B" Horses, lowered 31%; "C" Horses, raised 20%; "A" Cattle, lowered 25%; "B" Cattle, no change; "C" Cattle lowered 22%; Mules, lowered 21%; Hogs, lowered 12%; Wagons, lowered 26%; Automobiles, lowered 63%; Organs, raised 60%; Pianofortes, lowered 51%; Furniture, raised 15%; Machinery, raised 180%;

Goose Lake Township Values on "A" Horses, raised 20%; "B" Horses, raised 65%; "C" Horses, raised 80%; "A" Cattle, lowered 31%; "B" Cattle lowered 23%; "C" Cattle raised 47%; Mules, raised 74%; Sheep, no change; Hogs, raised 16%; Wagons, no change; Automobiles, lowered 15%; Pianofortes, raised 25%; Machinery raised 10%.

Hamilton Township, Values on "A" Horses, lowered 33%; "B" Horses, raised 3%; "C" Horses, raised 25%; "A" Cattle, lowered 28%; "B" Cattle, lowered 14%; "C" Cattle lowered 21%; Mules, lowered 6%; Sheep, lowered 25%; Hogs, lowered 30%; Wagons, no change; Automobiles, no change; Organs, lowered 37%; Pianofortes, lowered 10%; Furniture, lowered 50%; Machinery raised 200%.

Howard Township, Values on "A" horses, raised 50%; "B" Horses, raised 50%; "C" Horses, raised 170%; "A" Cattle, raised 11%; "B" Cattle, raised 52%; "C" Cattle raised 97%; Mules raised 72%; Sheep, raised 50%; Hogs, raised 17%; Wagons, raised 126%; Automobiles, raised 100%; Organs, lowered 25%; Pianofortes, raised 25%; Furniture, raised 100%; Machinery raised 100%.

Highland Township Values on "A" Horses, lowered 32%; "B" Horses, raised 6%; "C" Horses, raised 150%; "A" Cattle, lowered 40%; "B" Cattle, lowered 25%; "C" Cattle, lowered 33%; Mules, lowered 5%; Sheep, lowered 40%; Hogs, lowered 20%; Wagons, lowered 13%; Organs, lowered 33%; Pianofortes lowered 12%; Machinery raised 100%.

Jackson Township Values on "A" Horses, lowered 38%; "B" Horses, no change; "C" Horses, raised 45%; "A" Cattle, lowered 10%; "B" Cattle, lowered 3%; "C" Cattle, lowered 8%; Mules, lowered 2%; Hogs, lowered 12%; Wagons, raised 10%; Automobiles, raised 200%; Organs, raised 5%; Pianofortes, raised 85%; Furniture, raised 25%; Machinery, raised 10%.

Kennedy Township, Values of "A" Horses, lowered 6%; "B" Horses, raised 12%; "C" Horses, raised 65%; "A" Cattle, no change; "B" Cattle, raised 50%; "C" Cattle, raised 22%; Mules, raised 15%; Sheep, lowered 40%; Hogs, raised 40%; Wagons, raised 35%; Automobiles, raised 10%; Organs, no change; Pianofortes raised 100%; Furniture raised 50%; Machinery raised 100%.

COMMISSIONER'S RECORD, "3,"

13 Lake George Township Value on A" Horses, lowered 39%; B" Horses, lowered 6%; A" Cattle, lowered 5%; B" Cattle, No-change; C" Cattle raised 25%; Hogs, lowered 30%; Wagons, raised 54%; Automobiles, raised 200%; Organs - No-change Machinery, raised 200%.

14 La Roche Township, Values on A" horses - No-change. B" Horses, raised 25%; C" Horses, raised 54%; A" Cattle, raised 7%; B" Cattle, raised 50%; C" Cattle raised 17%; Mules, raised 25%; Sheep, raised 40%; Hogs, raised 40%; Wagons, raised 70%; Automobiles raised 265%; Organs raised 100%; Pianofortes raised 20%; Machinery, raised 900%.

15 Lawrence Township, Values on A" Horses, lowered 19%; B. Horses lowered 11%; C" Horses, raised 140%; A" Cattle, lowered 24%; B" Cattle, lowered 13%; C" Cattle, lowered 12%; Mules, lowered 18%; Shep. lowered 25%; Hogs, lowered 7%; Wagons, No-change; Automobiles lowered 25%; Organs lowered 60%; Pianofortes, lowered 25%; Furniture, No-change; Machinery raised 100%.

16 Lone Tree Township, Values on A" Horses, lowered 46%; B" Horses, lowered 29%; C" Horses raised 180%; A" Cattle, lowered 50%; B" Cattle, raised 5%; C" Cattle, raised 95%; Mules, lowered 40%; Sheep, no-change Hogs, lowered 14%; Wagons, raised 3%; Organs, No-change Pianofortes, raised 90%; Furniture, raised 100%; Machinery raised 30%.

17 Moore Township, Values on A" Horses, raised 22%; B" Horses, raised 23%; C" Horses, raised 125%; A" Cattle raised 29%; B" Cattle, lowered 35%; C" Cattle raised 34%; Mules, raised 45%; Sheep, raised 33%; Hogs, raised 89%; Wagons, raised 45%; Automobiles, raised 63%; Organs lowered 33% Pianofortes, raised 30%; Furniture, raised 50%; Machinery raised 150%.

18 Plain Center Township, Values on A" Horses ^{Lowered} 6%; B" Horses, lowered 8%; C" Horses Raised 66%; A" Cattle, lowered 12%; B" Cattle raised 3%; C" Cattle, lowered 11%; Mules, lowered 6%; Hogs, raised 5%; Wagons lowered 19%; Automobiles raised 275%; Organs lowered 37% Pianofortes raised 150%; Machinery raised 50%.

19 Platte Township, Values on A" Horses, lowered 33%. B" Horses, lowered 8%; C" Horses, raised 135%; A Cattle lowered. 37% B" Cattle lowered 12%; C" Cattle lowered 20%; Mules lowered 14%; Sheep, lowered 40%; Hogs, lowered 44% Wagons, raised 8%; Automobiles lowered 10% Organs lowered 30% Pianofortes lowered 50%; Furniture lowered 50% Machinery No-change.

CHARLES MIX COUNTY, SOUTH DAKOTA.

70 Ree Township, Values on A" Horses, lowered 14% B" Horses, lowered 7%
C" Horses Raised 200%; A" Cattle, lowered 25%; B" Cattle, no-change C"
Cattle, lowered 12%; Mules lower. 12%; Sheep, no-change. Hogs, lowered 12%.
Wagons, lowered 20%; Automobiles raised 100%; Organs lowered 20%.
Furniture raised 100%; Machinery raised 100%.

71 Rhoda Township. Values of. A" Horses lowered 28%; B" Horses, lowered 21%.
A" Cattle lowered 30% B" Cattle, lowered 25%; C" Cattle lowered 19%. Mules,
lowered 10%; Hogs lowered 22%. Wagons raised 33%. Automobiles raised 60%.
Organs, lowered 18%. Pianofortes, lowered 8%; Machinery No-change.

72 Rouse Township, Values on A" Horses, lowered 31% B" Horses lowered 12%;
C" Horses, raised 66%. A" Cattle lowered 41% B" Cattle, lowered 29% C" Cattle
lowered 25%, Mules lowered 31%; Sheep lowered 38%. Hogs lowered 47%.
Wagons No-change. Automobiles lowered 33%; Organs, lowered 44%.
Pianofortes No change. Furniture lowered 50% Machinery, No-change.

73 Signal Township Values on A" Horses raised 20% B" horses
raised 7% ; C" Horses, raised 200% . A" Cattle, no-change. B" Cattle
raised 50% . C" Cattle, raised 37% ; Mules raised 5% . Sheep. No-change
Hogs raised 19% . Wagons No-change ; Automobiles raised 45% ; Organs
lowered 55% ; Pianofortes, raised 25% ~~Furniture lowered 5%~~ Machinery raised 200%

74 Wakehe Township, Values on A" Horses, no-change B" Horses, raised 5% ;
C" Horses No-change. A" Cattle lowered 33% ; B" Cattle lowered 28% C" Cattle
raised 20% . Mules, lowered 15% ; Sheep. No-change ; Hogs, lowered 50% ;
Wagons, lowered 5% ; Automobiles, lowered 25% ; Organs, lowered 50% ;
Pianofortes lowered 58% ; Furniture, No-change. Machinery No-change.

75 White Swan Township, Values on A" Horses, raised 22% B" Horses,
raised 60% ; C" Horses, raised 150% ; A" Cattle raised 6% . B" Cattle,
lowered 6% C" Cattle raised 35% ; Mules, raised 55% Sheep, raised 23%
Hogs, lowered 4% . Wagons, raised 33% Automobiles raised 10% .
Organs lowered 42% Pianofortes raised 5% Furniture, No-change.
Machinery, raised 100% Elevators lowered 15% .

76 City of Platte, Values on A" Horses, raised 7% B" Horses, raised 36%
C" Horses, raised 54% A" Cattle raised 25% B" Cattle lower. 37%
Mules, raised 56% Hogs, No-change Wagons, raised 16% Automobiles
raised 5% Organs, No-change, Pianofortes lowered 33% . Furniture
No Change Machinery, No-change. Elevators raised 45% .

COMMISSIONER'S RECORD, "3,"

Perkins Bros. Co., Printers and Binders, Sioux City, Iowa.

27
City of Seddes. Values on A" Horses raised 15%. B" Horses raised 23%. C" Horses raised 150%. B" Cattle, lowered 19%. Mules lowered 37%. Hogs lowered 10%. Wagons lowered 50%. Automobiles raised 15%. Organs, lowered 55%. Piano fortes lowered 23%. Furniture, lowered 10%. Machinery No-change. Elevators No-change.

28
City of Wagner, Values on A" Horses, lowered 6%. B" Horses raised 30%. B" Cattle raised 6%. Mules lowered 37%. Hogs raised 40%. Wagons. No change. Automobiles raised 36%. Organs, lowered 54%. Piano fortes lowered 17%. Furniture raised 50%. Elevators, No-change.

29
City of Lake Andes. Values on A" Horses, lowered 50%. B" horses, raised 40%. C" Horses, raised 80%; B" Cattle lowered 21%; Mules, no-change. Wagons, lowered 17%. Automobiles, lowered 20%; Organs, No-change, Piano fortes, lowered 40%; Furniture, raised 20%. Elevators, raised 15%.

30
Town of Ravinia, Values on A" Horses - no-change; B" Horses, lowered 10%. B" Cattle, lowered 14%. C" Cattle, lowered 23%. Mules, lowered 40%. Hogs, lowered 53%; Wagons, lowered 50%. Automobiles, lowered 33%. Piano fortes, No-change; Furniture, No-change. Machinery, No-change. Elevators, lowered 10%.

31
Town of Dante, Values on A" Horses, lowered 25%. B" horses, lowered 28%; A" Cattle, lowered 20%; B" Cattle, lowered 25%; Hogs, lowered 30%. Wagons, no-change; Automobiles lowered 28%; Piano fortes raised 25%; Furniture, No Change; Machinery, No Change. Elevators, No-change.

32
On Motion the Board adjourned as a Board of equalization and proceeded, as a Board of County Commissioners.

33
On motion Board adjourned to meet July 16th 1913.
July 16th 1913:

The Board met as per adjournment, with same members present.

The Board, proceeded, with the semi-annual settlement checking Treasurer's and Auditor's Cash, Books and voucher records.

34
On motion Board adjourned to meet July 17th 1913.
July 17th 1913.

35
Board met as per adjournment with same members present, and spent the day, checking Treasurer's & Auditor's records.

On motion board adjourned to meet July 18th 1913

CHARLES MIX COUNTY, SOUTH DAKOTA.

July 18th 1913.

Board met as per adjournment, with same members present,

On motion Standard Bridge Co., was allowed, \$4000.⁰⁰, as second estimate on 1913 Bridge work.

On motion the following bills were allowed:

Name	Description	Amount
H E Fryle,	For Vital Statistic report.	\$12.75
T H Ward,	"	8.25
Vincent Kaberna	"	8.25
S P Jewett	"	1.00
E W Boyce	"	5.50
E W Wagner.	"	2.50
E H Roberken	"	4.00
Frank Patten	"	2.00
A T Cole.	"	4.25
J C Greenfield	"	2.50
R P Frank	"	1.50
P R Pinard	"	1.50
R H Townsley.	"	4.50
E M. Keeling	"	.50
Q L Rustad	"	4.75
A H Wise	"	3.00
J C Lyod.	"	7.50
E T Andersen	"	6.00
J A Seapy.	"	13.25
S D Carney.	"	3.75
J C Hallingworth	"	2.75
C A Brown	"	.50
W A Brother	"	.50
E W Curtis	"	1.00
L H Collier	"	.50
S A Kleckner.	"	.75
E E Day.	"	10.25
A J Macy.	"	2.5
Gustav Denker	"	2.5
B W LaShier	"	2.5
Geo. Waters	"	2.5
Wm Missing	"	2.5
J C Craig	"	2.5
E W Anderson	"	2.5
W. S. L. Henley.	"	2.75
T H Stewart	"	2.5
G. S. Warren	"	2.5

COMMISSIONER'S RECORD, "3,"

C. S. Langley.	For Vital Statistic Report.	50
H. M. Blazek.	" " "	25
John Lehr.	" " "	50
John Otto.	" " "	25
C. H. Burton	" " "	25
S. Sprecher.	" " "	25
H. C. White	" " "	25
Carl Peterson	" " "	25
H. J. Stuart	" " "	2.00

Board spent the day checking Treasurer's and Auditor's records,

On motion Board adjourned to meet July 19th 1913.

July 19th 1913. Board met as per adjournment, with same members present.

Board spent the day checking Treasurer and Auditor's records.

On motion Board adjourned to meet July 21st 1913.

Board as per adjournment, with same members present.

On motion the petition of J. W. Gethery and others, asking for the grading of Road between section 12-100-70 and section 7-100-69, was allowed.

On motion the petition for a steel bridge across Platte Creek, on section line running north and south between sections 22 and 23, 100-67, was rejected.

On motion petition to open highway between sections 10 and 11, 99-68, was rejected.

The quarterly statement of Supt. of Hospital for Insane, was approved as follows:

Name	Hospital Charge	Amount
Julia Kelly		\$ 48.00
Anton Kuca	" "	48.00
Augusta Manske	" "	48.00
Andrew McGary	" "	48.00
Jas. McKinnon	" "	48.00
Siebrin Mellma	" "	48.00
Peter Nyberg	" "	48.00
David Penrod	" "	48.00
Kate Peicka	" "	48.00

CHARLES MIX COUNTY, SOUTH DAKOTA.

Sam Severin	Hospital Charge	48.00
Chas Skull	" "	48.00
F. W. Tuckerman	" "	48.00
Nettie McKay	" "	48.00
P. H. Kaney	" "	34.13
Benjamin Lilly	" "	32.53

Board of Health met Present R P Frink
C F Anderson, Absent A B Beck, after taking the required
oath, the following bills were allowed.

S D Carney, Quarantining & disinfecting Waly family to S Langley Disinfecting (Claimed 23.00 allowed.	14.00
C. A. Brown Quarantining School House.	32.15
C. S. Langley Disinfecting W. Smith, home	10.00
P R Pinard	10.00
Wagner Drug Co Disinfectants	4.20
J A Seapy. Attending Board of Health meeting	6.75
C F Anderson	11.80
R P Frink	21.25

County Board spent the balance of day.
Checking Treasurer's & Auditor's records.

On motion Board adjourned to meet July 22, 1913

July 22, 1913

Board met as per adjournment, with same

On motion County Auditor, was instructed to
issue refunding order to J. A. Wagner, for 1912 taxes on C² of NC⁴
13-95-62, which tax had been erroneously paid said tax was
re-extended on tax list.

Board spent the day checking Treasurer's and
Auditors records.

On motion Board adjourned to meet July 23, 1913.

July 23, 1913.

Board met as per adjournment, with same members
present,

On motion the following bills were allowed.

F. C. Fryle	Phys	in Lilly Insanity Case	5.00
W. H. McCall	Attendance & Mileage	" " " "	5.20
F. H. Ward	Judges Fee	" " " "	4.75
F. C. Fryle	Phys	" Kaney " "	5.10
R P Frink	"	" " " "	7.20
F. H. Ward	Judges Fee	" " " "	4.85

COMMISSIONER'S RECORD, "3,"

H. E. Foye.	Physician	in Williams Insanity Case	8 ²⁰
W. F. McCall	Attendance	" " " "	2 ¹⁰
Pat Evans.	Witness Fee	" " " "	2 ¹⁰
Ed. Ashin	" "	" " " "	2 ¹⁰
E. T. Anderson	Physician	" " " "	5 ⁰⁰
T. F. Ward.	Judges Fee	" " " "	7 ⁹⁵
Williamson Bros.	Provisions for Co-poor. Dodd.		20 ⁰⁰
Mrs. Reinhart, Danley, and. Roraart.	Washing for Co-poor. Jensen family		40 ⁰⁰
Cora E. Stone	Expense, conducting 8 th grade examination		24 ⁵³
Cora E. Stone	Office expense of Co-Supt.		27 ⁵⁰
Fred Shoop.	Assessing Town of Ravinia		55 ⁰⁰
The Wheeler Courier.	County Printing		93 ²⁰
The Wheeler Courier	Printing Notices By order of Board of Health		5 ¹⁰
State Treasurer, Chas Marshall.	26 Copies of 1913 Session Laws.		26 ⁰⁰
	Water for Court House.		9 ⁵⁰

The alleged claim of Albert Vandre of \$200.⁰⁰ for damages, claimed to have been sustained by reason of alleged dangerous condition of highway in Platte township was on motion rejected.

The claim of Thos Hunter of \$25⁰⁰ for use of land on section 11-96-65, during last five years, when road was un-passable, and repairs on bridge, was on motion rejected.

The Board spent, balance of day, checking Treasurer's and Auditor's records.

On motion Board adjourned to meet July 24th 1913.

July 24th 1913
Board met as per adjournment, with same members present.

The Board completed the checking of Treasurer's and Auditor's records, and finding the records correct, on motion same was approved.

The Board checked the record of the Register of Deeds on fees collected, and finding the record correct, on motion same was approved.

The Board checked the record of the Clerk of Courts on fees and fines collected, and finding the record correct, on motion same was approved.

CHARLES MIX COUNTY, SOUTH DAKOTA.

On motion the following bills were allowed:

E H Robertson,	Justice fees in case of State vs ^{B.F.} Morgan	3.15
F. J. Twohig	Witness " " " " " " " "	3.50
J. N. Reinhart	" " " " " " " "	3.50
Harry Thompson	" " " " " " " "	3.50
Harry Thompson	Marshall " " " " " " " "	3.20
H. C. Schneider	Justice fees " " " " " " " "	7.65
Harry Thompson	Marshall " " " " " " " "	9.00
Mat Kotal	Witness " " " " " " " "	1.70
Jos Turek Sr.	" " " " " " " "	1.70
Jos Valenta	" " " " " " " "	1.70
F. E. Bouza.	" " " " " " " "	1.70
Jos Krsnak.	" " " " " " " "	1.70
John Cihak.	" " " " " " " "	1.70
Vincent Kaberna	Justice fees in case of State vs ^{B.F.} Morgan	4.20
Wm. Hinkley	Constable " " " " " " " "	6.20
Vincent Kaberna	Justice " " " " " " " "	4.95
W. E. Exon	Deputy Sheriff fees. ^{P.H.} Kaney.	3.25
A. J. Macy.	Justice fees in case of State vs Char McKelips	4.70
Wm. Hartung.	Witness " " " " " " " "	1.10
E. W. Boyce	Justice fees " " " " " " " "	3.55
	Claimed 4.95 Allowed	
E. W. Boyce.	Justice fees. Case State vs Jos Seuring	2.70
	Claimed 3.30 Allowed.	
E. W. Boyce	Justice fees. Case State vs Metta Purdee	1.30
E. W. Boyce	" " " " " " " "	4.40
	Claimed 5.90 Allowed.	
E. W. Boyce	Justice fees. Case State vs Metta Purdee	2.55
	Claimed 4.40 Allowed.	
Maggie Smith	Witness fees. Case State vs Metta Purdee	1.10
Cathel Smith	" " " " " " " "	1.10
Mrs E. Danley.	" " " " " " " "	1.10
L. W. Ripple	" " " " " " " "	1.10
E. W. Boyce	Justice fees Case State vs Walter McCarl.	4.25
	Claimed 5.25 Allowed	
L. W. Ripple	Witness fees Case State vs Walter McCarl	1.10
J. A. Harrington	" " " " " " " "	1.10
Alice McCarl.	" " " " " " " "	1.10
Geo Cool.	" " " " " " " "	1.10
E. W. Cross	" " " " " " " "	1.10
Clyde R. Cross.	" " " " " " " "	1.10
E. W. Stuart	Auto hire	20.60

COMMISSIONER'S RECORD, "3,"

Perkins Bros. Co., Printers and Binders, Sioux City, Iowa

C W Boyce	Justice fees in case of State vs A B Reynolds.	Claimed ^{\$6.45} Allowed	5.35
C W Dodge	Witness	State vs A B Reynolds	3.00
J R Harrington, Marshall	3.50
Carl Peterson	Witness	2.30
Carl Nimmeman	"	1.10
Ella Nimmeman	"	1.10
P. A. Harford	"	1.10
J R Harrington	"	1.10
A B Reynolds	"	1.10
Myrtle Shuck	"	1.10
Mrs. Hulbert	"	1.10
John Sluter	Juror.	1.10
Elmer Smith	"	1.10
Dell Sherman	"	1.10
J. Nies	"	1.10
Ed. Linn	"	1.10
J. W. Hill	"	1.10
C W Boyce	Justice Matter M Carl	Claimed 3.50 Allowed 3.00
L W Raffle	Witness fees Case of State vs Walter M Carl.	1.10
Alice M Carl	"	1.10
J. A. Harrington	"	1.10
C. W. Boyce	Justice fees Case of State vs R. Mather	Claimed 3.50 Allowed.	2.70
L W Raffle	Witness fees Case of State vs R Mather	1.10
Clyde R Cross	"	1.10
C W Boyce	Justice fees Case of State vs Metta Purdee	3.30
Maggie Smith	Witness	1.10
Ethel Smith	"	1.10
L. W. Raffle	"	1.10
L C Tutley	Juror.	1.10
Jack Burk	"	1.10
George Gregory	"	1.10
H. Miller	"	1.10
L C Button	"	1.10
E Henty	"	1.10
L D Gramblit	Physician for Co-poor. Mrs Jones	Old. 10 ⁰⁰ Allowed 5.00	
L D Gramblit	"	Mrs French	
L		Claimed 16.50 Allowed 11.00	
L D Gramblit	Physician for Co-poor. Henry Mader.	Claimed 30.50 Allowed 15.00	

COMMISSIONER'S RECORD, "3,"

Perkins Bros. Co., Printers and Binders, Sioux City, Iowa.

The sealed bids on file, for the grading of certain bridge approach and roads, were opened and examined by the County Board, and on motion contracts, were awarded to the lowest bidder as follows:

Frank Haney and M D Barker, Grading on North and South section line between sections 16-17 Township 94, Range 62.

Total 2100 Cubic yards. @ 16 cents per Cubic yard.

Frank Haney and M D Barker. Grading of bridge approach on East and West section line between Indian allotment Lot 8 Township 94, Range 62, and Lot 942-943 Township 93, Range 62.

Total 1900 Cubic yards. @ 14 cents per Cubic yard.

On motion it was ordered that the Western Engineering Company, Yankton, S. D. furnish the County, with a complete set of Government field notes, in plat form of Charles Mix County, at \$3.50 per Township.

On motion Auditor was authorized to issue refund order to S. H. Raymond, for \$2.00 for erroneous payment of Motor Vehicle License.

On motion Auditor was authorized to issue refund order to Thos. Kubal of 2.00 for erroneous payment of Motor Vehicle License.

On motion the following bills were allowed,

Standard Bridge Co Balance due on 1913 Bridge Contract	\$ 2630.39
W. H. Brazzell Per diem, Committee work & Mileage	90.00
E. d. Astin " " " " " "	14.10
Joseph Lindquist " " " " " "	38.00

On motion Board adjourned.

Attest

W. J. Kaberna,
County Auditor

Joseph Lindquist
Chairman

CHARLES MIX COUNTY, SOUTH DAKOTA.

Proceedings of the Board of County Commissioners
Wheeler, S. D. Oct 7th 1913.

The Board of County Commissioners met in regular session with all members present. Jas. Lundquist Chairman Wm F. Brazzill, Ed Astin and F. Haberna Auditor.

After the minutes of the last meeting were read and approved. the following business was transacted

The report of H. K. Langeland County Treasurer, showing list of Delinquent Personal tax, was considered and on motion was ordered re-extended on tax list of said County.

On motion Auditor was instructed to issue refund order to Thos. Gardner of Lone Tree Township for \$50⁰⁰, on account of erroneous assessment on personal property for the years 1910-1911

On motion Auditor was instructed to issue refund order to Adolph Walking of Lawrence Township for \$16²⁸ on account of erroneous assessment on personal property for the year 1912

On motion the personal tax of J. D. Evans for the year 1911 City of Lake Under, was ordered abated on account of erroneous assessment.

On motion Auditor was instructed to issue refund order to J. H. Nichols for \$5²⁸, on account of erroneous assessment for the years 1909 to 1912 inclusive on the following described property. Beginning 80 feet South of SW Corner of lot 9 Block 8 in the town of Wheeler East 150 feet South 150 feet West 150 feet North 150 feet to place of beginning, the above ~~legally~~ ~~described~~ ~~was~~ ~~assessed~~ and the taxes paid on same described as follows viz: S 1/2 of S 1/2 of NW 1/4 Sec. 1-96-68

On motion the petition of Yankton College, Yankton S. Dak. asking for abatement of the 1913 Tax assessment, on the E 1/2 section 14-100-67, was granted and ordered abated for the reason, same is exempt from taxation

On motion, the request of Nash. of Carroll township asking for an appropriation to be expended on grading approach to bridge was allowed. at \$150⁰⁰, Auditor was instructed to issue warrant drawn on County Road Fund. in favor of the Treasurer of Carroll Township.

COMMISSIONER'S RECORD, "3,"

Perkins Bros. Co., Printers and Binders, Sioux City, Iowa.

On motion the claim of Johnson Bros Land Co. for a refund of the personal tax of Maurice L. Ingalls was rejected for the reason that it appeared that the tax was a superior lien to a mortgage foreclosed by applicant after the tax had become delinquent.

On motion the amount of \$500⁰⁰, was appropriated to the Charles Mix County Fair Association, and Auditor instructed to issue County warrant for same.

On motion the claim of Bon Homme County for \$3041.⁹⁹ being one half of cost of construction of Bridge on County line between Charles Mix County and Bon Homme County across Dry Choteau Creek, being where the section line between sections 30 and 31 Township 94, Range 61 Bon Homme County, S. D intersects with said Creek was rejected, for the reason that the building of said bridge was not authorized by the Board of County Commissioners of Charles Mix County, that said bridge was built in violation of a contract between said Counties and was built without notice to or the consent of said Charles Mix County S. D.

On motion the following bills were allowed.

Bank of Geddes	Witness Certi #1	5.25
Comil State Bank (P)	Court Certi #863	6.10
Ray Coulon	" " #1514	28.80
V. J. Pisecha	" " #1519	27.80
Lakeside State Bank	" " #1503	4.80
L M Adams -	" " #1520	26.10
Bank of Geddes	" " #1566	16.70
Bank of Geddes	" " #1531	25.20
First State Bank	" "	155.00
Harry Smith	Bailiff	24.20
Comil State Bank (P)	Court Certi #1511-1534	29.00
Comil State Bank (P)	" " #1533	3.00
Co. Seat State Bank	" "	436.10
Comil State Bank	" "	30.90
Anton Hanomichl	" " #1541	31.20
N T Dinsmore	" " #1540	37.10
J. H. Seitle	" " #1544	38.20
J. A. Nash	" " #1510	29.30
Noah. Montagne	" " #1543	35.70

CHARLES MIX COUNTY, SOUTH DAKOTA.

Anton Chytha	Court Certi # 1546	32.70
Wm Leary.	Court Certi # 1545	32.70
Chas. Jink	" " 1524	26.10
Merton Davis	" " 1523	31.70
Carl Petersen.	" " 1525	27.00
A L. Vogelsang	" " 1527	29.60
S T Hansen	" " 1526	25.80
Wm Hildebrand	" " 1528	28.70
B. S. Klevon	" " 1550	32.50
T S Silvis	" " 1516	27.10
John Nedved.	" " 1542	34.80
A W Kremer.	" " 1522	37.20
Platte State Bank.	Witness Certi	9.60
Platte State Bank.	Court "	30.80
Platte State Bank.	" "	19.60
Chas Mix Co Bank.	Witness " 864	3.20
Chas Mix Co Bank.	Court 1521	25.50
S P Jewett	Justice Fees. State vs S J Connell	3.30
S P Jewett	" " " " Morgan.	2.95
S P Jewett	" " " " John Doe.	1.95
S P Jewett	" " " " Circus	1.45
S P Jewett	" " " " John Doe.	1.95
Farmers State Bank. (P)	Witness Certi # 816	2.10
G M Easter,	" " # 788	2.10
L W Ripple	Sheriff's Cash expended for prisoners	97.94
L. W. Ripple	Sheriff's Fees for quarter ending Sept 30/13	537.75
L. W. Ripple	Sheriff's Jailors Fees " " " "	59.00
Geddes Clothing Co.	Clothing for Co Poor. (Wood)	5.95
Spaulding & Johnson.	Painting Court House.	106.00
Henry. Coal.	Cot & mattress for jail	5.00
Farmers Elev. Co.	Geddes Coal for Co Poor. (Mosher)	176.5
A B Beck	Stater. Athy Expense Acct.	89.95
Al Sprague	Draying Coal for Co Poor. (Williams-Baker)	6.00
Floete Lumber Co,	Coal for Co-Poor. (Casper)	10.55
Harry Smith	Janitor Court House.	4.00
J H Ineal & Co. Wagner.	Culverts and Lumber	113.92
Turner County	Court expense, State vs Fullerton Lumber Co ^{Case of}	1390.19
G. C. Graf.	Provisions for Co Poor. Baker.	3.35
Pat Evans	Care of County Poor. Williams	60.00
F M Chastian,	Hauling Chairs & Desks for Court House ^{From Platte}	5.00
Mamie Kaberna.	Boarding Jarons.	23.45
J H Ineal & Co. Platte,	Lumber for Bridges	31.80
L. Signal,	Stenographer. Fee. State & Criminal Cases.	25.00

COMMISSIONER'S RECORD, "3,"

Perkins Bros. Co., Printers and Binders, Sioux City, Iowa.

Platte Tribune	County Printing	5.450
J. L. Minahan	House rent for County Poor. Mosher Claimed 100,000 Alld.	70.00
S. P. Jewett	Justice Fees. Case of State vs Steckley	3.30
S. P. Jewett	" " " " " " " " Peterson	8.20
Frank. Dolejsi	Witness " " " " " "	2.80
A. J. Gilbert	" " " " " "	2.50
W. Barada	" " " " " "	1.10
Bert Tucker.	" " " " " "	1.10
Chas Reynolds.	" " " " " "	2.70
Gary Reynolds.	" " " " " "	2.70
Adolph. Sejnoka.	" " " " " "	2.20

On motion the Board of County Commissioners adjourned to meet. Oct 8th 1913

Oct. 8th 1913.

The Board of County Commissioners met as per adjournment with same members present. and on motion the following bills were allowed.

S. P. Jewett	Justice Fees	Case State vs Dan Helmer.	4.30
S. P. Jewett	" " "	" " " " Speakman	2.80
J. M. Peterson	Witness Fees	" " " " "	3.00
W. E. Beck.	" " "	" " " " "	3.00
Frank Bell.	" " "	" " " " "	3.00
S. P. Jewett	Justice Fees.	" " " " "	2.80
H. A. Reichman	Witness " "	" " " " "	3.00
Louis Rainstad	" " "	" " " " "	3.00
John O. Thonvold.	" " "	" " " " "	3.00
S. P. Jewett	Justice Fees.	Case State vs Robinson	2.80
S. P. Jewett	Justice Fees	Case State vs Summers.	5.45
A. L. Clements	Witness Fees	" " " " "	1.10
Rudolph Casek.	" " "	" " " " "	1.10
David Berhman	" " "	" " " " "	1.10
Mrs John Kukrall	" " "	" " " " "	1.10
H. C. Endman.	" " "	" " " " "	2.70
John Bellitt	Justice Fees.	Case State vs Danville.	3.10
Jay. Welsh.	" " "	" " " " "	1.10
H. C. Tucker.	" " "	" " " " "	1.10
Wm Minahan	" " "	" " " " "	1.10
J. H. Mayhaus.	" " "	" " " " "	1.10
Fred Ruble.	" " "	" " " " "	1.00
John Kreitel	" " "	" " " " "	1.10
S. P. Jewett	Justice Fees.	Case State vs Deuschle	3.90

CHARLES MIX COUNTY, SOUTH DAKOTA.

R H Tournley.	Phys for County Poor. (Stastrey)	12.00
J L. Fredine	Mede " " " (Williams)	2.15
Educator Supply Co.	County Supplies	24.50
J H Deuschle.	School Books for County Poor.	4.41
J H Nichols	Free + Post office box rent. Claimed 42 ⁵⁰ Allowed.	37.50
C F Carroll	Reg. of Deeds. Clerk hire July, Aug, Sept.	63.06
C F Carroll	Reg of Deeds. Toll calls of County officers	16.25
C F Carroll	Postage for. July. Aug. Sept.	21.98
Farmers Elevator Co, Seddes,	Lumber for. County (Court House)	125.10
Farmers Elevator Co, Seddes	Cement. for. County. (Court House)	8.66
Roy C. Willy	Attorney by order of Court.	25.00
Missouri River Tel. Co.	Toll calls for County Officers	19.25
Rovaart Bros	Provisions for County Poor. (Stastrey)	10.00
Glen Clark.	Fencing Court yard.	20.10
C F Carroll	Reg of Deeds. Recording County Deed.	1.40
L T Hoaglin	Counting Printing, Court Calander. & notices	57.95
M Jaurineh	Provisions for County Poor. (Lauerian + Clements)	24.30
Rovaart Bros	Provisions for County Poor. (Stastrey)	20.00
Frank Horak.	House rent and milk for County Poor. (Stastrey)	34.30
B F Reynolds.	Mede for. County	15.26
H C Nordaker.	Provisions for. County Poor. (Bobeldyk)	30.00
Mitchell Publishing Co.	County Supplies	53.36
Chas Mix County News.	Printing for. County Supt.	17.75
Record Printing Company.	County Printing	16.25
Albert Amundson.	Provisions for County Poor. (Cushman)	91.66
Brown ^{3rd} Saenger.	County Supplies	22.00
C F Churchill,	Wire for Court yard fence.	3.80
L. E. Campfeld	Attending 8 th Grade examinations	18.00
Record Printing Co.	Printing for. County Superintendent	8.00
Educator Supply Co,	County Supplies	15.00
J E Craig	Clerk of Courts Postage	7.00
J E Craig	Clerk of Courts, Clerks fees September Term Court.	110.00
F N Havens	Work on Court House.	76.50
Smith Stevenson	Hauling Court yard fence.	10.00
Calta Bros	Mede for. County	1.40
Chas. Marshall	Water for Court House	17.00
Cora E Stone	Refund on Examination fees.	2.00
H K. Langeland	Postage Treasurers office	26.00
H J Haberna	Postage + Express. July, Aug. Sept	25.25
County Seat State Bank.	Exchange on Drafts. less County interest	15.80
Henry Cool.	Furniture for. Court House	169.25
Waren Barada.	Deputy Sheriff fees for. quarter ending Sept 30/13	234.50
H H Ward.	Office supplies	5.59

CHARLES MIX COUNTY, SOUTH DAKOTA.

Bernice Danley.	Witness fees.	State vs Steckly	1.50
Leo Bruner.	" "	" "	1.70
F. B. Fryle.	" "	" "	1.10
C. H. Robertson	Justice fees	State vs John Doe. Claimed 4.50 allowed	3.50
Frank Dolejci	Witness fees.	State vs Doe.	1.60
Bert Tucker.	" "	" "	1.10
C. H. Robertson	Justice fees.	State vs Rezek.	2.95
Adrian Carlson	Witness fees.	" "	2.40
Nels Anderson	" "	" "	2.40
Frank. Patton	Justice fees	State vs Ray. Claimed 7.20 Allowed.	4.00
Geo Abdalla	Witness "	" " " "	2.00
Frank Verba	" "	" "	2.00
Dr. Townsley.	" "	" "	1.00
Ferris Norris	" "	" "	2.00
Frank. Patton	Justice fees.	State vs Harris	2.70
Frank Patton	Justice fees	State vs Hodges and Holmes.	1.45
Emory. Morgan	Marshall fees.	" " "	6.00
E. W. Boyce.	Justice fees.	State vs Haley.	2.70
E. W. Boyce.	Justice fees.	State vs Haley.	2.70
E. W. Boyce	Justice fees.	State vs Devaney. Claimed 4.90	3.80
E. W. Boyce	Justice fees.	State vs Day. Claimed 4.90	3.80
Ed. Ashin	Per diem, mileage and Committee work.		25.70
W. H. Brazzill	" "	" "	74.90
Jos. Lindquist	" "	" "	27.50

The Clerk of Courts having filed a request to have the jury list extended to two hundred names. the Board of County Commissioners complied with the above request and the following names were chosen to keep the jury list of two hundred ^{names} intact

James Honnrichl	Bryan Twp.	H. V. Daily	Highland Twp.
Geo R. Cole.	Carroll Twp.	J. G. Hunston.	Jackson Twp.
John H. Beltrnan	Carroll Twp.	H. Hupsmith.	Jackson Twp.
Pat Cully.	Castalia Twp.	Frank. Jaeger.	Jackson Twp.
Chris Chresman	Choteau Creek Twp.	W. A. Robbenolt	Kennedy Twp.
Theo. Deurmeier	Choteau Creek Twp.	R. E. McFarland.	Kennedy Twp.
Tom Gibbons	Darlington Twp.	J. E. Pierce	Kennedy Twp.
Albert DeJong.	Darlington Twp.	Henry Dimick	Lake George Twp.
W. M. Anderson	Forbes Twp.	R. E. Brown	Lake George Twp.
J. W. Bare	Goose Lake Twp.	C. S. Godfrey.	Lawrence Twp.
John Carda	Goose Lake Twp.	Frank Gale.	Lawrence Twp.
David Hayes.	Goose Lake Twp.	John Hurst	Moore Twp.
Robert Hawk.	Goose Lake Twp.	J. R. Carda.	Moore Twp.
E. C. Mortensen	Howard.		

COMMISSIONER'S RECORD, "3,"

Perkins Bros. Co., Printers and Binders, Sioux City, Iowa

E Bucholz.	Ree Twp.	E K Shaw	City of Wagner.
Joseph. Boka	Ree Twp.	S L. Gable Jr.	City of Wagner.
J. W. Carroll	Rouse Twp.	J. C. Stasky	City of Wagner.
James. Hutchinson	White Swan	E. C. Schreiber	City of Wagner.
J. H. Moran	White Swan	G. W. Bullock.	City of Wagner.
E. Larson.	City of Platte	V. H. Varinek	City of Wagner.
A. C. Kuipers	City of Platte	W. D. Savage.	City of Lake Andes.
C. C. Lien	City of Platte	H. J. Overseth	City of Lake Andes.
J. W. Beemer.	City of Platte	Gus. Busche.	City of Lake Andes.
Geo. Ford.	City of Platte	E. F. Piroutch	Town of Ravinia
Wm Beebe	City of Platte		

On motion the claim of Hugh C. Leebce, of \$87.15 for surveying and making plans for Brown Bear Drainage ditch project was allowed.

On motion the County Board adopted plans and specifications now on file in the office of County Auditor to be used in the construction of Steel Bridges and cement Culverts for the year 1914 and the County Auditor was instructed to advertise for bids and set the time of letting at 2, o'clock P.M. December 1st 1913.

On motion the Board adjourned to meet December 1st 1913.

Attest: F. J. Kaberna County Auditor,

Joseph Lindquist
Chairman

Proceedings of the Board of County Commissioners
Wheeler, S. D. Dec. 1st 1913

The Board of County Commissioners met pursuant to adjournment taken Oct 8th 1913. Members Present Jos Lindquist Chairman Ed. Astin Wm F. Brazzell and F. J. Kaberna Auditor.

The Board, having under consideration the proposals submitted for the erection of all necessary steel and concrete bridges to be constructed upon the roads and highways within Charles Mix County, South Dakota for the year 1914 found the following bids submitted by the following competing bridge companies in accordance with the plans and specifications on file with the County Auditor:

CHARLES MIX COUNTY, SOUTH DAKOTA.

	Midwest Bridge Co. Omaha Neb.	Midland Bridge Co. Omaha Neb.	Minnesota Bridge Co. Minneapolis Minn.	Federal Bridge Co. Minneapolis Minn.	Mont. & Dak. Bridge Co. Des Moines Ia.	Texas City Bridge Co. Texas City Mo.	Standard Bridge Co. Minneapolis Minn.	Omaha Ave.
For pin connected bridges with 1600# Capacity with two lines of angle railing designed to carry wood floor, steel joists and floor.								
Spans 36 to 44' per lineal foot.	\$15.00	18.10	16.75	16.00	15.60	15.30	14.20	
" 45 to 49' " " " "	15.50	18.60	17.10	16.50	16.00	15.75	14.85	
" 50 to 54' " " " "	15.85	19.25	17.60	17.00	16.50	16.00	15.35	
" 55 to 59' " " " "	16.00	21.00	17.80	17.00	16.50	16.35	15.65	
" 60 to 64' " " " "	16.55	21.00	18.00	17.45	17.50	17.00	16.00	
" 65 to 69' " " " "	17.20	22.00	18.00	17.45	17.50	17.35	16.80	
" 70 to 74' " " " "	17.65	22.50	19.00	18.35	18.50	18.00	17.15	
" 75 to 80' " " " "	18.10	23.00	20.00	19.00	19.50	19.00	17.55	
For pin connected bridges 1600# Capacity with angle railing designated to carry concrete floor and including steel joists and wood floor.								
Spans 36 to 44' per lineal foot.	\$18.75	21.00	19.50	19.00	19.90	19.50	18.20	
" 45 to 49' " " " "	20.20	23.00	21.60	21.40	21.15	21.00	19.80	
" 50 to 54' " " " "	20.95	23.50	22.00	21.60	21.15	21.00	20.85	
" 55 to 59' " " " "	22.20	23.75	23.00	22.75	22.60	22.40	21.90	
" 60 to 64' " " " "	23.35	25.00	24.00	23.75	23.85	23.65	22.95	
" 65 to 69' " " " "	24.40	26.00	25.00	24.80	24.90	24.85	23.85	
" 70 to 74' " " " "	25.60	28.00	26.60	26.00	25.95	26.00	24.85	
" 75 to 80' " " " "	26.50	32.00	26.90	27.00	26.85	26.95	25.90	
For riveted bridges with angle railing 1600# designed to carry concrete floor and including steel joists and wood floor.								
Spans 36 to 44' per lineal foot.	\$19.00	22.00	20.65	20.00	19.90	20.00	18.85	
" 45 to 49' " " " "	21.10	24.00	21.90	22.00	21.35	21.40	20.90	
" 50 to 54' " " " "	22.20	24.50	22.95	23.00	22.40	22.35	21.85	
" 55 to 59' " " " "	23.50	24.74	23.85	24.00	23.90	24.00	23.05	
" 60 to 64' " " " "	24.10	26.00	25.00	25.00	24.25	24.40	23.85	
" 65 to 69' " " " "	25.20	27.00	27.20	27.00	26.00	25.65	24.95	
" 70 to 74' " " " "	25.40	28.00	28.50	28.00	28.00	25.40	24.95	
" 75 to 80' " " " "	26.35	32.25	29.85	29.00	26.40	26.30	26.10	
For 1600# 9 Beam superstructure with Railing to carry concrete floor and wood floor.								
Spans up to 14' per lineal foot.	8.35	9.00	8.85	8.90	8.60	8.50	8.00	
" 15 to 18' " " " "	10.10	11.15	10.40	10.35	10.45	10.50	9.80	
" 19 to 20' " " " "	12.00	13.50	12.80	12.35	12.40	12.50	11.80	
" 21 to 28' " " " "	13.00	15.00	14.95	14.00	13.50	13.00	12.90	
" 29 to 34' " " " "	16.25	18.10	16.95	16.50	16.40	16.10	15.80	

COMMISSIONER'S RECORD, "3,"

Continued from Page 511

For prices in 8 lines of steel joists consisting of two channels & I beams of the sizes given below:							
8 lines of 6" joists per lineal foot.	\$ 4.00	4.30	4.00	4.10	3.95	3.90	3.55
" " " 7" " " " "	4.10	4.35	4.50	4.25	4.10	4.00	3.80
" " " 8" " " " "	5.00	5.70	5.50	5.35	5.25	5.10	4.75
" " " 9" " " " "	5.50	6.55	5.95	6.00	5.75	5.60	5.00
" " " 10" " " " "	6.20	7.00	6.95	7.00	6.40	6.30	6.20
" " " 12" " " " "	10.20	11.40	10.50	10.10	10.25	10.15	9.90
" " " 15" " " " "	12.50	12.90	12.85	12.50	12.65	12.40	11.85
" " " 18" " " " "	---	18.00	17.75	17.00	16.50	16.15	15.65
For steel tubes per foot of each tube including concrete, pier beams and struts and swags.							
Tubes 30 inch in dia. 1/4 metal	\$ 6.35	7.10	8.10	8.00	7.25	7.00	6.25
" 36 " " " " "	7.50	9.25	9.35	9.00	8.00	8.00	6.75
" 42 " " " " "	8.00	10.10	9.55	10.00	8.75	9.00	7.35
For Channel Caps for steel or wooden bridges	1.00	1.10					
6" Channel Caps. 2 channels.	1.00	1.10	1.10	1.25	1.10	.95	.85
7" " " " " "	1.25	1.90	1.45	1.50	1.20	1.30	1.10
8" " " " " "	1.50	2.40	1.70	1.75	1.60	1.50	1.45
For steel piles driven in place per lineal foot of the following sizes.							
Six inch I Beam piles	1.00	1.10	1.30	1.25	1.20	1.25	.90
Seven " I " " "	1.25	1.90	1.35	1.40	1.85	1.30	1.00
Eight " I " " "	1.65	2.40	2.00	1.80	1.70	1.65	1.45
Nine " I " " "	1.75	2.90	2.25	2.00	1.85	1.80	1.65
Ten " I " " "	2.00	3.20	2.50	2.25	2.10	2.00	1.85
Eight Col. special	3.00	3.75	3.00	3.45	3.25	3.10	2.75
For any concrete abatements built per cubic yd.							
Above water line	\$ 13.50	14.25	15.50	14.10	14.00	13.65	11.95
Below water line	14.35	17.50	16.75	15.25	15.00	14.90	13.95
Concrete backing	12.85	13.00	14.75	14.25	14.00	13.00	11.95
Concrete floor per lineal foot.	6.50	7.10	6.45	7.00	6.75	6.40	5.75
Reinforcing rods used in concrete backing per 100 ^{ft} in place.	4.50	5.00	4.80	4.65	4.85	6.40	4.50
Washington fir lumber in place per thousand feet.	38.50	43.00	42.50	41.50	45.00	42.00	34.45
Washington fir piles per foot.	.40	.55	.50	.48	.41	.48	.39
Red Cedar piling per foot	.39	.53	.45	.42	.41	.42	.38
Standard wood bridges 16 foot roadway per lineal foot of superstructure	4.10	5.25	4.30	3.95	4.15	4.30	3.95

Continued next page

CHARLES MIX COUNTY, SOUTH DAKOTA.

After fully examining the proposals of the competing Bridge Companies, on motion the contract for the construction of bridges in and for Charles Mix County, South Dakota, for the year 1914, was awarded to the Standard Bridge Company, Omaha, Nebraska, their bid being the lowest bid, it was ordered that a contract for one year be entered into, with said company according to the plans and specifications with their bid.

The bid of the Geddes Building Company for concrete culverts at \$17.85 per cubic yard was deemed unsatisfactory and on motion was rejected.

On motion County Auditor was instructed to issue refund order to K. K. Langeland, County Treasurer, for \$9.60 on 1912 tax receipt #6421, said tax receipt being erroneously issued the tax was ordered re-extended on 1912 tax list.

On motion Goose Lake Township was allowed \$350.⁰⁰ to be expended in road improvements, County Auditor was instructed to issue County warrant payable to the Treasurer of Goose Lake Township.

On motion the following bills were allowed:

J. F. Spotts, Concrete Culvert & grading approach	Howard Twp	\$264.60
J. F. Spotts, First estimate on Contract, for Road work	" "	567.00
J. H. Dugal & Co. Dante Metal Culverts for Rouse Township		418.39
Haney & Son's Grading road between Wakeke & Ree Twp's		47.50
Ed. Bradley, First estimate on Contract for Roadwork Highland Twp.		236.25
Fred Brewster Labor on road, grade, between Lake George & La Roche Twp.		45.00
Edward Brewster, " " " " " " " "		45.00
Herman Holders, " " " " " " " "		45.00
Wm Nelson, " " " " " " " "		90.00
Harve Holden, " " " " " " " "		45.00
Tom Astin, " " " " " " " "		40.50
Ed. Astin, " " " " " " " "		45.50
Commercial State Bank (W)	Court Certificate #877	11.10
L. C. Kroh,	Witness Certificate #867	17.30
Commercial State Bank, (P)	" " #784	2.10
" " " (P)	" " #1556-1538	15.80
" " " (P)	" " #1558	3.00
James Marshall,	Bailiff September term of Court.	24.20
Warren Barada	" " " " " "	19.50
Bank of Geddes.	Court Certificate #1529	28.80
Temple Theater Co.	Rent of hall for Co-Institute meeting	10.00
Frank Haney & M. D. Barber,	1st estimate on Road grading Rouse Twp.	498.00
E. F. Pratte	Labor on roads Wakeke Twp.	20.00

Continued next Page

COMMISSIONER'S RECORD, "3,"

Ed. Curtin,	Committee work. per diem + mileage	39.50
Wm H Brazzill	" " " "	72.00
Jos. Lindquist	" " " "	43.50
On motion the following bills were allowed and ordered drawn on the Automobile License Fund:		
Harve Holden.	Labor. on County Roads.	22.50
Herman Holden.	" " " " " "	9.00
O. L. Roberts	" " " " " " + Auto hire	101.50
Mike O'Hare.	" " " " " "	22.50
Ed Curtin	Labor. on County Roads. + expense Connected with same.	61.95
A. W. Jansen,	Labor. + Paint for sign boards on Co. Roads.	11.25
Ed. Bradley.	Labor. on County Roads.	240.50

On motion Board. adjourned without day.

Attest

H. J. Haberna.

County Auditor

Chairman

Proceedings of Board of County Commissioners January 6th 1914 Wheeler S. Dak.

The Board of County Commissioners met in regular session, Members Present Jos. Lindquist, Chairman, Ed. Curtin, Wm H Brazzill, H. J. Haberna Auditor

The minutes of the last meeting were read and approved.

On motion it was moved and seconded, that Wm H Brazzill act as chairman of the Board of County Commissioners for the year 1914, Motion Carried

The application of Hemming Anderson for a refund of \$6.95 on 150 X 33 feet in the NW 1/4 of SE 1/4 section 6-97-66, was allowed for the reason of double assessment on said property for the year 1912.

The application of Mrs. Allie Trewartha for a refund of taxes for the year 1910 and 1911 on the NW of SW 1/4 sec 15-99-70 was allowed, for the reason that final proof has not been made on said land.

On motion the County Treasurer. was instructed to redeem from tax sale of 1913 the NW of SW sec. 15-99-70 same being erroneously assessed to said.

On motion Wm H Brazzill, was appointed a committee of one to negotiate with the County Commissioners of Bon Homme County, with reference to a change in the division of the County line for Bridge work. by substituting one section line in place of another heretofore bridged by the Commissioners of Bon Homme County.